

TCI Part Number	HP	Amps (A)	---uH +8%/-2%	Approx Weight (LBS)
KTR45A65HG	150	86	615	95

D

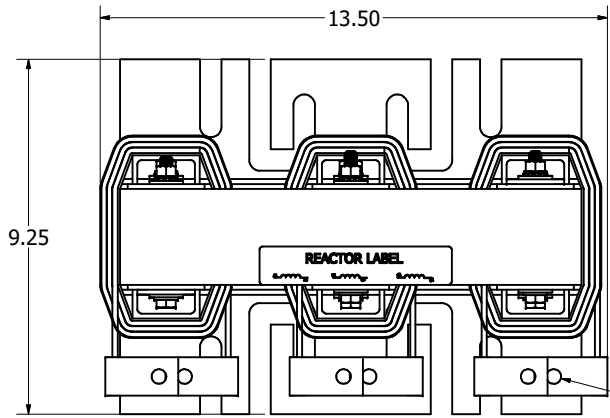

0.38 Dia Holes
6 Places

C

B

A

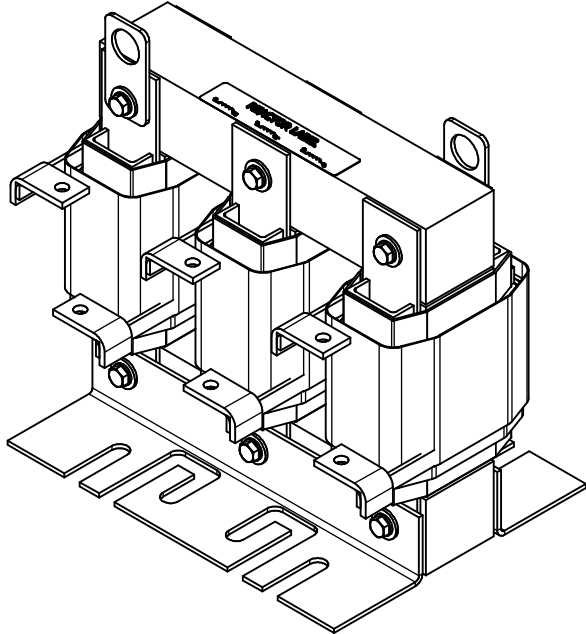
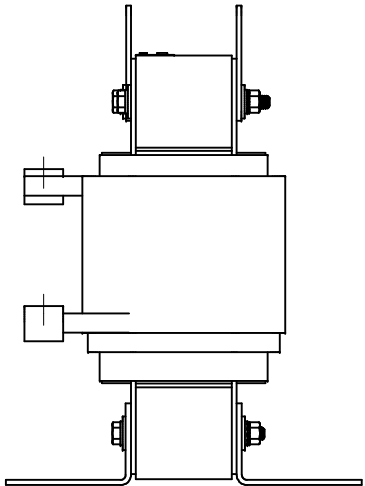
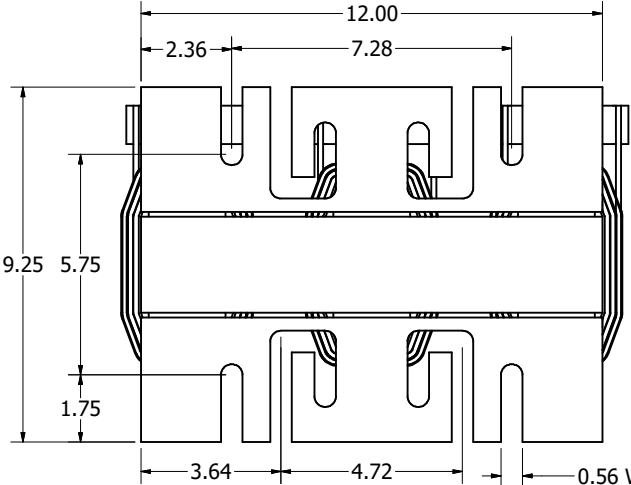
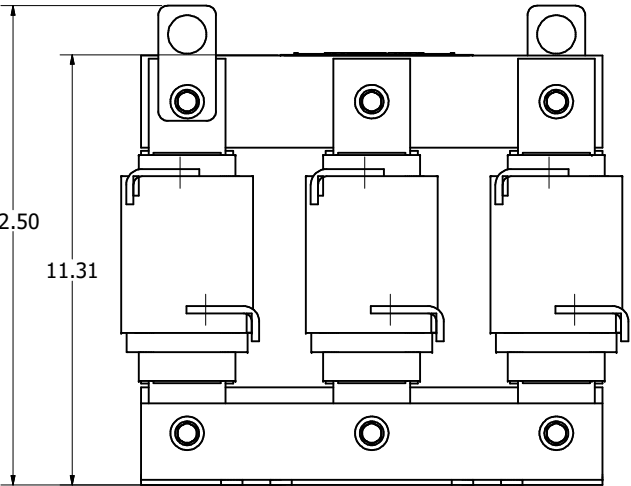

Customer Is Responsible For Installation to
Meet All National And Local Electrical Codes.

Material(s) Shall be RoHS Compliant

THE INFORMATION AND DESIGNS CONTAINED IN THIS DRAWING ARE CONFIDENTIAL AND THE PROPRIETARY PROPERTY OF ALLIED MOTION TECHNOLOGIES INC. AND ITS SUBSIDIARIES. NEITHER THIS DESIGN NOR ANY INFORMATION CONTAINED IN THIS DRAWING MAY BE REPRODUCED OR DISCLOSED TO OTHERS WITHOUT THE EXPRESS WRITTEN CONSENT OF ALLIED MOTION TECHNOLOGIES INC. AND ITS SUBSIDIARIES.				TOLERANCES (EXCEPT AS NOTED)		TCI An Allied Motion Company KTR45A65HG 5th Tuning Inductor 102307DG	W132N10611 (Rev 13 Feb 2023) Germanboro, NJ 08022 © 2023 TCI, LLC
				DECIMAL	.XX ± .25 .XXX ± .10		
C	6387, Redesign	8/23/2023	DSW	FRACTIONAL	± 1/32	OWN BY DSW	DATE 1/25/05
B	2661, add ee	3/12/10	DSW	ANGULAR	± 1°	SCALE 1/2.5	REVISED C
A	2565 tolerance chg.	06/09/08	DSW				
NO	REVISION	DATE	BY				