

TCI Part Number	HP	Amps	uH +8%/-2%	Weight (LBS)
KTR013A65HE	10	3.5	25000	13

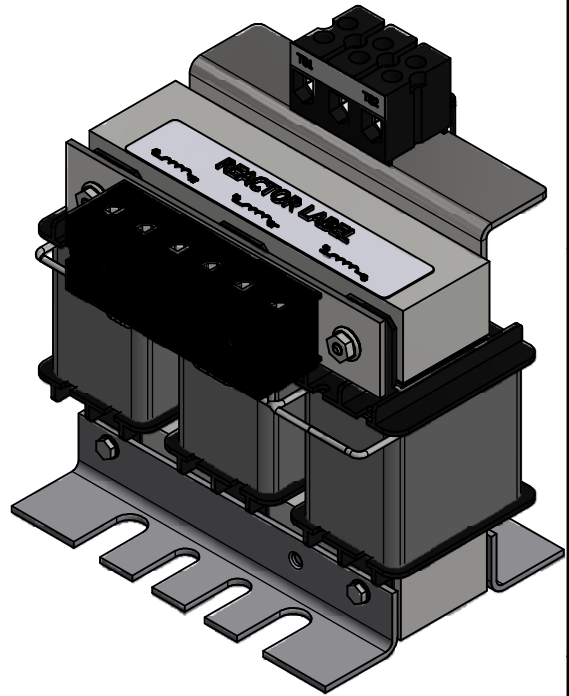

Thermal Switch  
Terminal Block

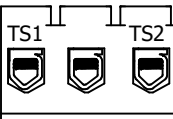

Wire Range: 18 AWG To 4 AWG.  
Torque: 20 LB-IN (2.3 Nm)  
Switch Opens on Temperature Rise  
Contact Rating: 6A @ 120 VAC

Note: Markings, A1,A2,B1,B2,C1,C2  
for Reference Only.

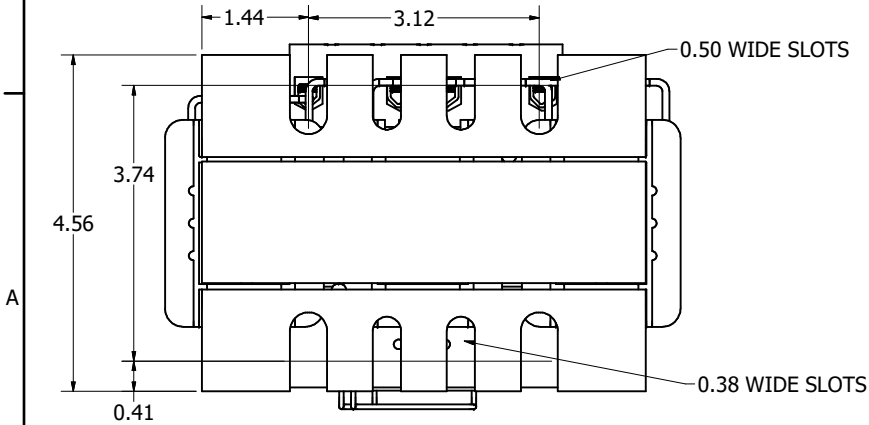
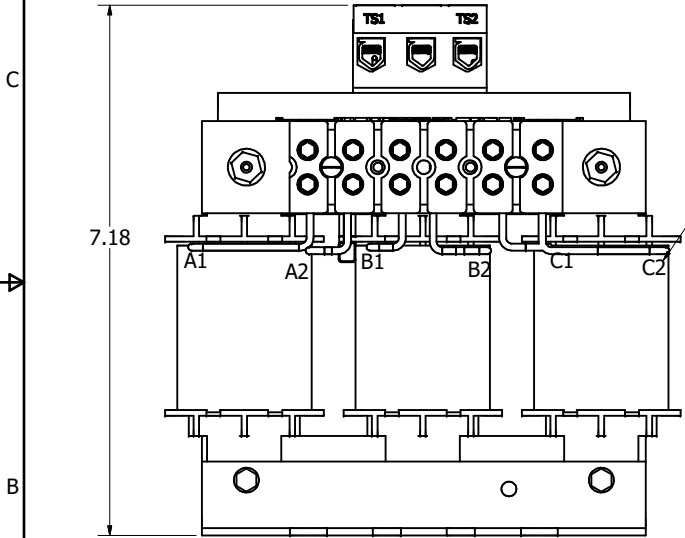
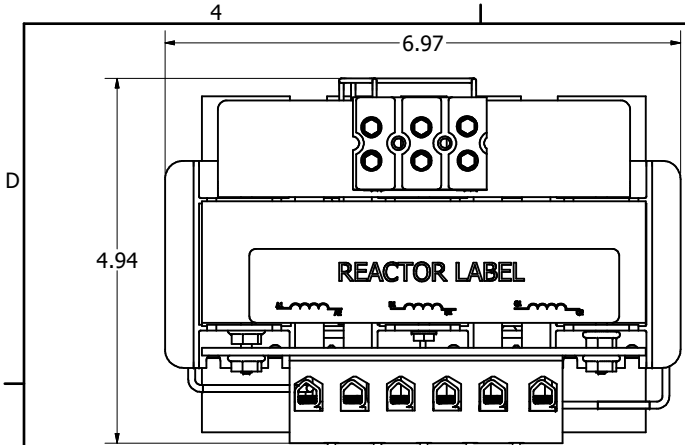
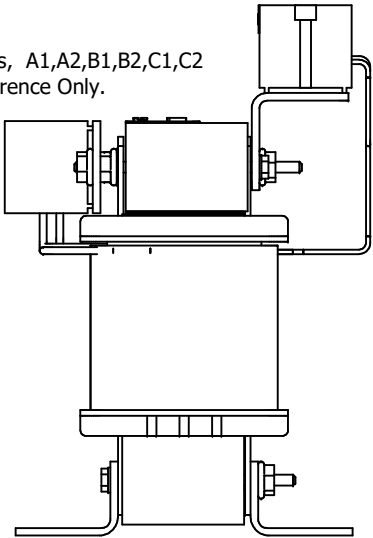

THE INFORMATION AND DESIGNS CONTAINED  
IN THIS DRAWING ARE CONFIDENTIAL AND THE  
PROPRIETARY PROPERTY OF ALLIED MOTION  
TECHNOLOGIES INC. AND ITS SUBSIDIARIES.  
NEITHER THIS DESIGN NOR ANY INFORMATION  
CONTAINED IN THIS DRAWING MAY BE  
REPRODUCED OR DISCLOSED TO OTHERS  
WITHOUT THE EXPRESS WRITTEN CONSENT OF  
ALLIED MOTION TECHNOLOGIES INC. AND ITS  
SUBSIDIARIES.

NO	REVISION	DATE	BY	ANGULAR
A	As Designed	9/22/2022	DSW	± 1/16
NO				± 1°

TOLERANCES (EXCEPT AS NOTED)	OWN BY	DATE	SCALE	REV	SHT
DECIMAL .XX ± .25 .XXX ± .10	DSW	9/22/2022	1:1.3	DSW	1
FRACTIONAL ± 1/16					

**TCI** W132N10611 (Rev 13 Feb 2022)  
Germanboro, NJ 08022  
© 2022 TCI, LLC  
KTR013A65HE, HSE, 10HP  
109261DG  
SHT 1 OF 1