

GENERAL PURPOSE, 1/3R, COLOR: GREY.

GROUND LUG 280 LBS : APPROX WEIGHT.
 WIRE RANGE: 2/0-#6 AWG
 TORQUE: 120 LB-IN

PART NUMBER: KMG130CG010000
 FOR SCHEMATIC SEE DRAWING# 26941.

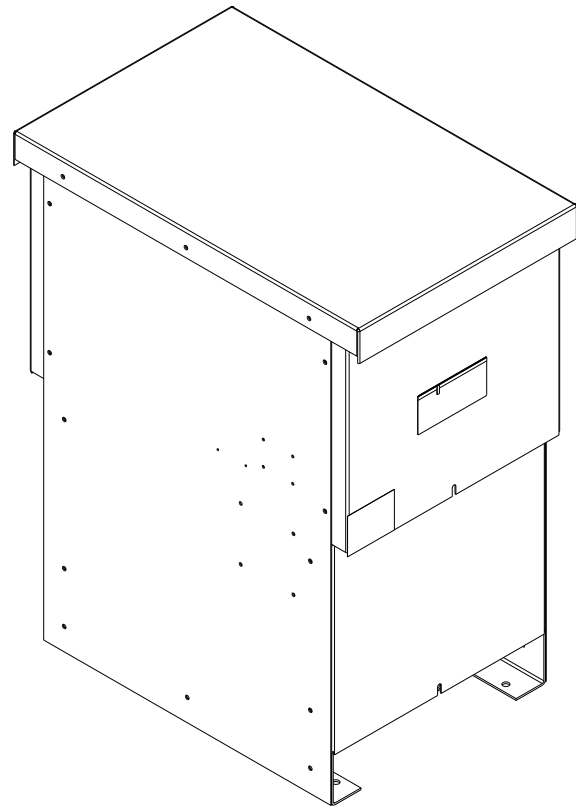

KMG HIGH PERFORMANCE OUTPUT FILTER
 PART NUMBER: KMG130CG010000
 FLA: 130 DRAWING#: 103940DG
 SYSTEM VOLTAGE: 600V SCHEMATIC: 26941
 HZ: 80
 PHASE: 3 ENCLOSURE TYPE: 1/3R
MOTORGUARD

CUSTOMER CONNECTIONS
 (.28 DIA HOLES 6 PLACES.)

T1 T2 T3
 U V W

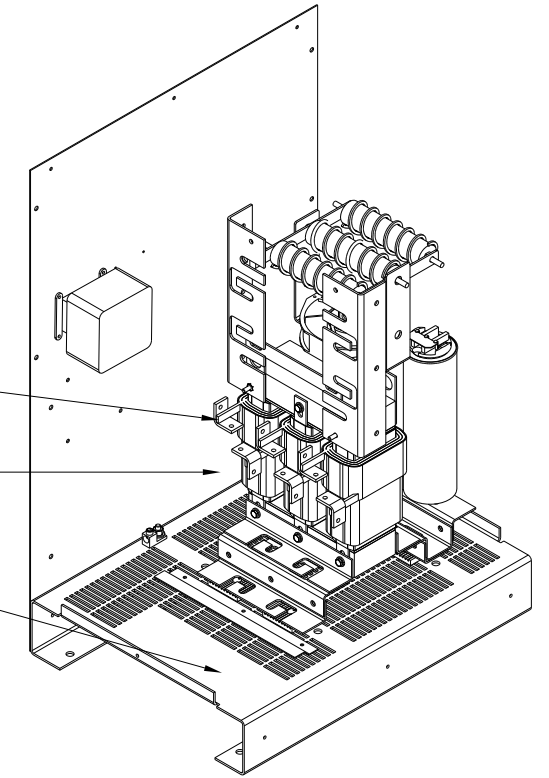

CUSTOMER WIRE ENTRANCE AND EXIT LOCATION.

DANGER
 HIGH VOLTAGE

PRIMARY FUSES .80_AMPS
 CLASS CC TIME DELAY

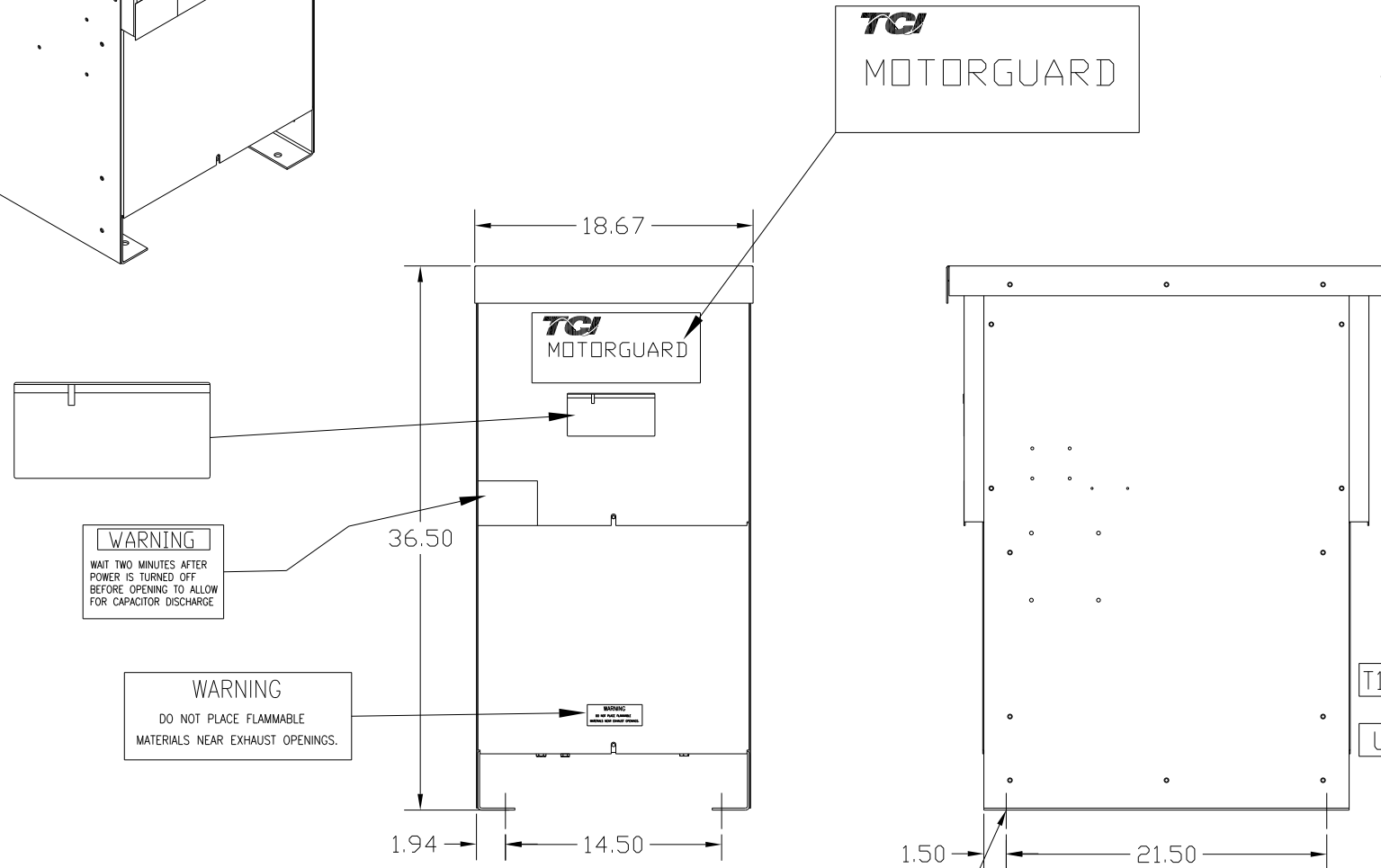

WARNING
 WAIT TWO MINUTES AFTER
 POWER IS TURNED OFF
 BEFORE OPENING TO ALLOW
 FOR CAPACITOR DISCHARGE

WARNING
 DO NOT PLACE FLAMMABLE
 MATERIALS NEAR EXHAUST OPENINGS.

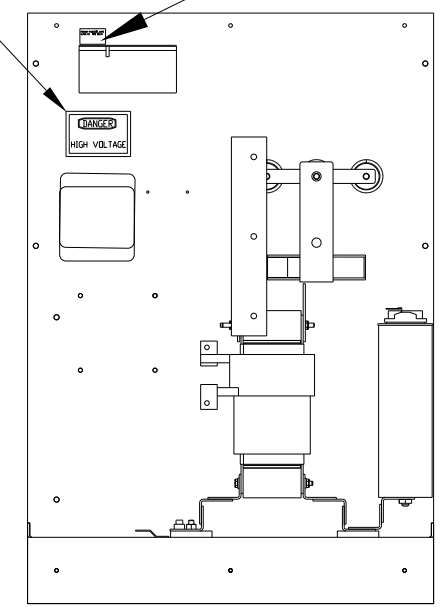
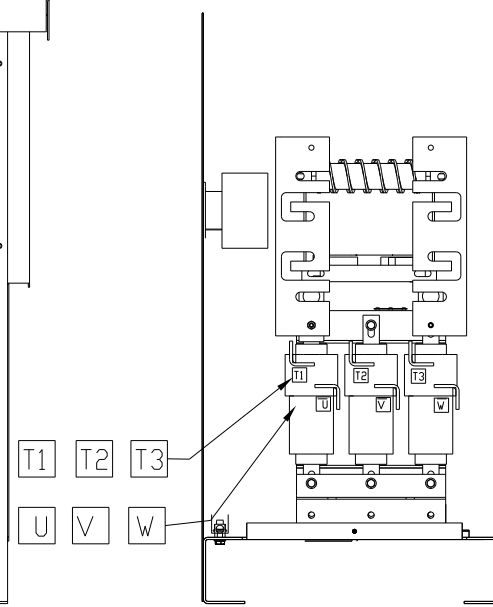

.56 DIA HOLES
 4 PLACES.

CUSTOMER IS RESPONSIBLE FOR INSTALLATION
 TO MEET ALL NATIONAL AND LOCAL ELECTRICAL CODES.

				TOLERANCES (EXCEPT AS NOTED)		TGI 7878 N. 86th STREET MILWAUKEE, WI 53224	
				DECIMAL			
				.XX ± .03		KMG, LRC FILTER STANDARD 130 AMP 600/3/80, 1/3R	
				.XXX ± .01			
				FRACTIONAL		DRN. BY DSW DATE 02/05/09 DWG. NO. 103940DG	
				± 1/32			
				ANGULAR		SCALE TO FIT APPRVD. C	
				± 1/2°			
NO	REVISION	DATE	BY			SHT. 1 OF 1	