

LABEL PLACED ON INSIDE WALL OF CABINET.

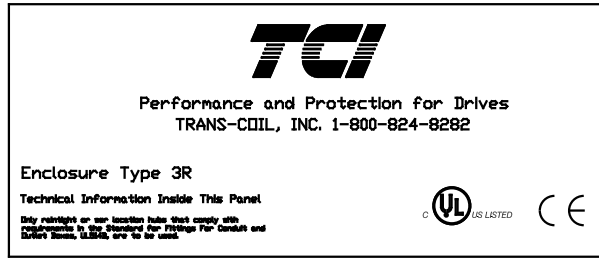

LABEL PLACED ON FRONT OF CABINET.

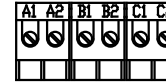

NOTE: A1, A2, B1, B2, C1, C2, MAKING'S ON TERMINAL BLOCK FOR REFERENCE ONLY.

BLOCK WIRE RANGE #12-#18 AWG
TIGHTENING TORQUE. 10 LB-IN

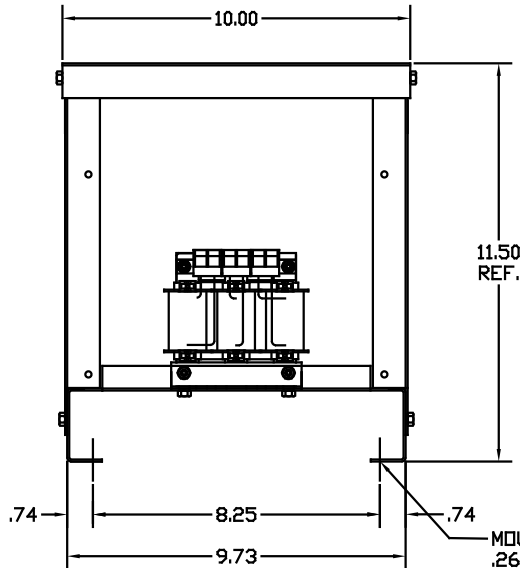

MOUNTING
.265 DIA HOLES
4 PLACES

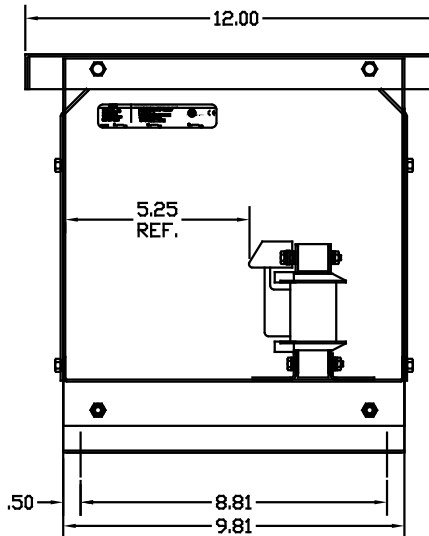
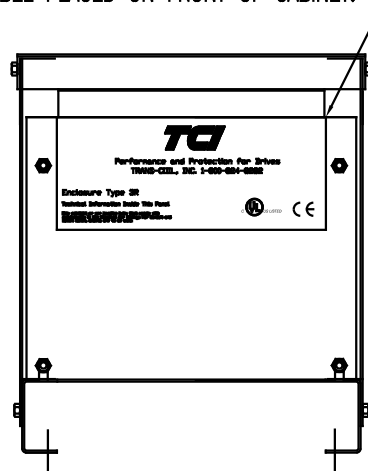

| CATALOG NO | VOLTS(V) | __PH±10% | __AMPS(A) | APPROX WT-LBS |
|--------------|----------|----------|-----------|---------------|
| KLRL2ATBE3R | 14.40 | 11.03 | 2 | 19.00 |
| KLRL2BTBE3R | 7.20 | 5.51 | 2 | 19.00 |
| KLRL2CTBE3R | 24.00 | 18.38 | 2 | 19.00 |
| KLRL2DTBE3R | 17.25 | 13.21 | 2 | 19.00 |
| KLRL2ETBE3R | 28.75 | 22.02 | 2 | 19.00 |
| KLRL2FTBE3R | 8.62 | 6.60 | 2 | 19.00 |
| KLRL3ATBE3R | 14.40 | 7.35 | 3 | 19.00 |
| KLRL3BTBE3R | 7.20 | 3.68 | 3 | 19.00 |
| KLRL3CTBE3R | 24.00 | 12.25 | 3 | 20.00 |
| KLRL3DTBE3R | 17.25 | 8.81 | 3 | 19.00 |
| KLRL3ETBE3R | 28.75 | 14.70 | 3 | 20.00 |
| KLRL3FTBE3R | 8.62 | 4.40 | 3 | 19.00 |
| KLRL4ATBE3R | 14.40 | 5.51 | 4 | 19.00 |
| KLRL4BTBE3R | 7.20 | 2.76 | 4 | 19.00 |
| KLRL4CTBE3R | 24.00 | 9.19 | 4 | 20.00 |
| KLRL4DTBE3R | 17.25 | 6.61 | 4 | 20.00 |
| KLRL4ETBE3R | 28.75 | 11.00 | 4 | 20.00 |
| KLRL4FTBE3R | 8.62 | 3.30 | 4 | 19.00 |
| KLRL6ATBE3R | 14.40 | 3.68 | 6 | 20.00 |
| KLRL6BTBE3R | 7.20 | 1.84 | 6 | 19.00 |
| KLRL6DTBE3R | 17.25 | 4.40 | 6 | 19.00 |
| KLRL6FTBE3R | 8.62 | 2.20 | 6 | 19.00 |
| KLRL8ATBE3R | 14.40 | 2.76 | 8 | 20.00 |
| KLRL8BTBE3R | 7.20 | 1.38 | 8 | 19.00 |
| KLRL8FTBE3R | 8.62 | 1.65 | 8 | 20.00 |
| KLRL12BTBE3R | 7.20 | .919 | 12 | 19.00 |
| KLRL12FTBE3R | 8.62 | 1.10 | 12 | 19.00 |

CUSTOMER IS RESPONSIBLE FOR INSTALLATION TO MEET ALL NATIONAL AND LOCAL ELECTRICAL CODES.

FINISH:
VENDOR - LILLY POWDER COATINGS, INC.
PRODUCT CODE - 312E
COLOR - PEBBLE GRAY
POWDER TYPE - POLYESTER-POLYURETHANE
PAINT SUITABLE FOR OUTDOOR APPLICATION PER UL TYPE 3R AND APPLIED PER A UL ACCEPTED DTVV2 COATING PROGRAM.

| NO | REVISION | DATE | BY | TOLERANCES EXCEPT AS NOTED |
|----|----------|------|----|----------------------------|
| | | | | DECIMAL |
| | | | | .XX ± .03 |
| | | | | .XXX ± .01 |
| | | | | FRACTIONAL |
| | | | | ± 1/32 |
| | | | | ANGULAR |
| | | | | ± 1/2° |

TCI 7878 N. 86th STREET
MILWAUKEE, WI 53224

KLRUL, TYPE 3R, FRAME A

DRN BY **DSW** DATE **09/28/04** DWG NO. **B** KLRAE3R-1DG
SCALE **TO FIT** APPRVD. **B** SHT. 1 of 1