

Performance and Protection for Drives:
KLR Series Line Reactor
 TCI
 7878 N. 86th St., Milwaukee, WI 53224
 414-251-4200

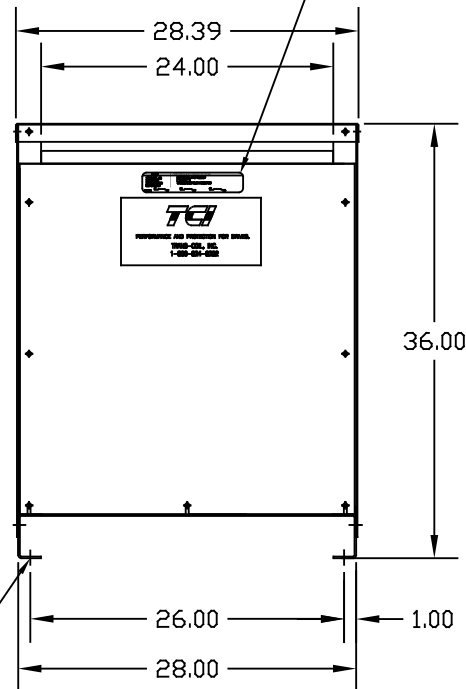

.50 DIA MOUNTING HOLES 4 PLACES.

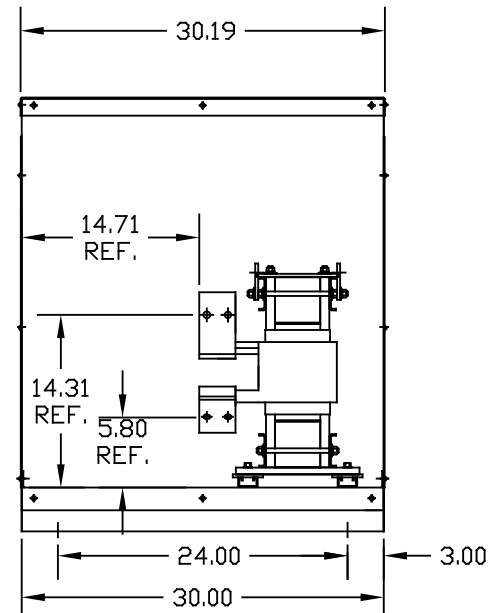

CUSTOMER IS RESPONSIBLE FOR INSTALLATION TO MEET ALL NATIONAL AND LOCAL ELECTRICAL CODES.

690V	NEC MOTOR HP	CATALOG NO	__AMPS(A)	APPROX WT-LBS	WATTS LOSS	TERMINAL HOLE SIZE
5% Z	900	KLR950ECB7V	950	450	1100	.53 DIA HOLE

TOLERANCES (EXCEPT AS NOTED)			
DECIMAL	.XX	±.03	
	.XXX	±.010	
FRACTIONAL	± 1/16		
ANGULAR	± 1/2°		
NO	REVISION	DATE	BY



7878 N. 86th STREET
 MILWAUKEE, WI 53224

**KLR SERIES 3 PH REACTOR
 690V (FRAME X) ENCLOSED**

DRN. BY DSW DATE 03/30/07
 SCALE TO FIT APPRVD.

DWG. NO. KLR950ECB7VDG
 SHT. 1 OF 1