

| CATALOG NO  | VOLTAGE | NEC MOTOR HP | NEC MOTOR CURRENT | WATTS LOSS | APPROX. WEIGHT-LBS | TORQUE (LB-IN) |
|-------------|---------|--------------|-------------------|------------|--------------------|----------------|
| KDRULA7HE3R | 480     | .75          | 1.6               | 15         | 19                 | 10             |

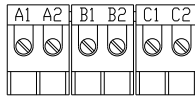
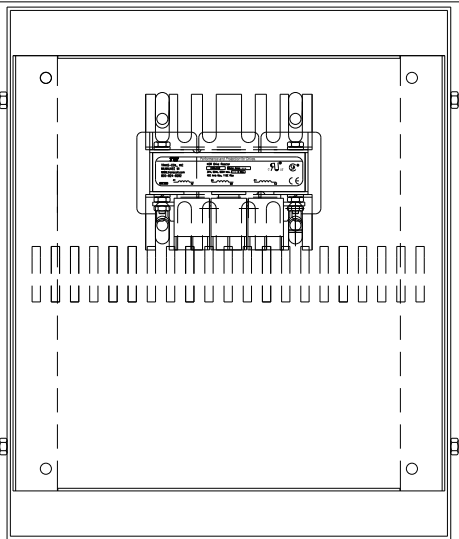

TERMINAL BLK MARKING

NOTE: A1, A2, B1, B2, C1, C2, MAKING'S ON TERMINAL BLOCK FOR REFERENCE ONLY.

NOTE 1: WATTS LOSS WILL VARY DUE TO FUNDAMENTAL FREQUENCY, CARRIER FREQUENCY AND OTHER SYSTEM CHARACTERISTICS.

KDR DRIVE REACTORS COMPLY WITH THE THERMAL AND ALTITUDE STANDARDS SET FORTH BY NEMA ST20-1992..

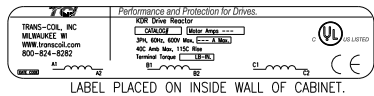

LABEL PLACED ON INSIDE WALL OF CABINET.

NEC MOTOR CURRENTS SHOWN IN THE 208/240 VOLT CHART ARE BASED ON HORSEPOWER AT 208 VOLT. 575/600 VOLT CHART USE THE 575 VOLT CURRENT RATING.

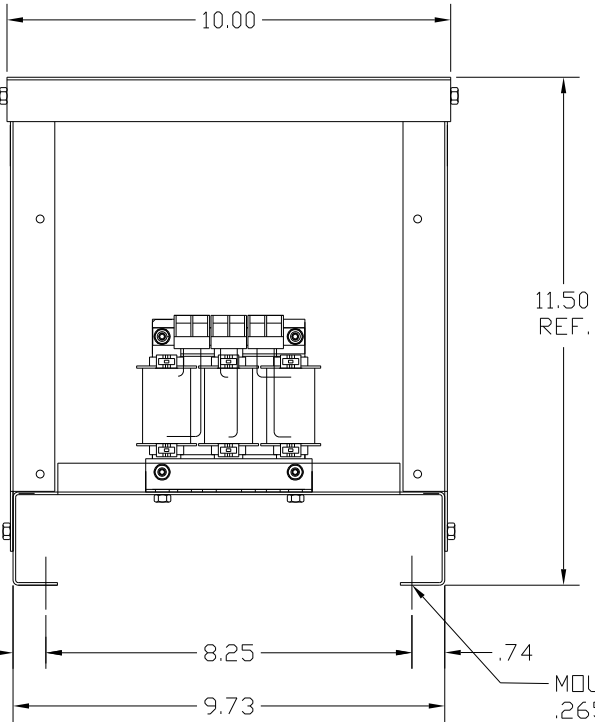

MOUNTING .265 DIA HOLES 4 PLACES

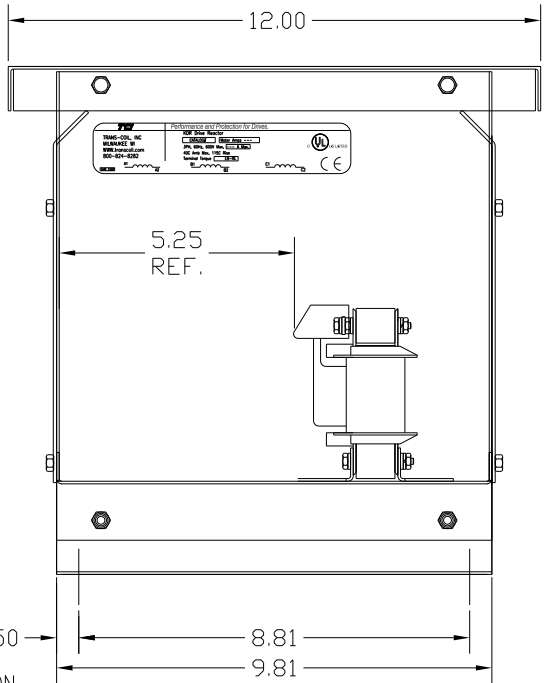
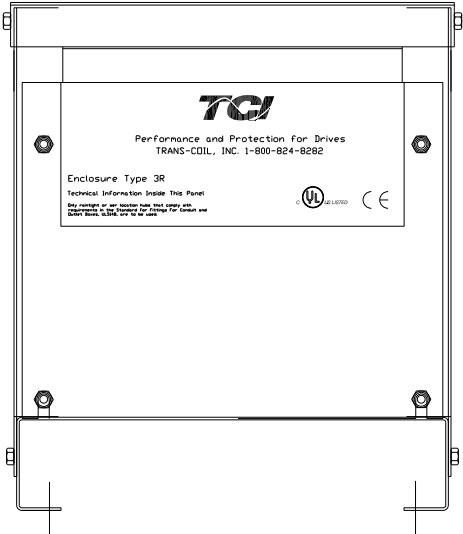

CUSTOMER IS RESPONSIBLE FOR INSTALLATION TO MEET ALL NATIONAL AND LOCAL ELECTRICAL CODES.

NOTE: USE ONLY HUBS OR FITTINGS THAT COMPLY WITH UL514B FOR TYPE 3R ENCLOSURES.

FINISH:  
 VENDOR - LILLY POWDER COATINGS, INC.  
 PRODUCT CODE - 312E  
 COLOR - PEBBLE GRAY  
 POWDER TYPE - POLYESTER-POLYURETHANE  
 PAINT SUITABLE FOR OUTDOOR APPLICATION PER UL TYPE 3R AND APPLIED PER A UL ACCEPTED DTVV2 COATING PROGRAM.

|             |  |              |  |  |  |
|-------------|--|--------------|--|--|--|
|             |  |              |  | 7878 N. 86th STREET<br>MILWAUKEE, WI 53224   |  |
|             |  |              |  | KDR DRIVE REACTOR<br>480V, ENCLOSED, TYPE 3R   |  |
| DRN. BY DSW |  | DATE 9/20/04 |  | DWG. NO.   |  |
| SCALE       |  | APRVD.       |  | KDRULA7HE3R3D  |  |
| NO          |  | REVISION     |  | DATE BY  |  |
|             |  |              |  | TOLERANCES (EXCEPT AS NOTED):<br>DECIMAL<br>.XX ± .03<br>.XXX ± .01<br>FRACTIONAL<br>± 1/32<br>ANGULAR<br>± 1/2° |  |
|             |  |              |  | SHT. 1 of 1  |  |