

(Customer Connections) Markings On Terminal Block For Reference Only.

Wire Range: 4-18 AWG.
Torque : 20 IN-LBS (2.3 Nm)

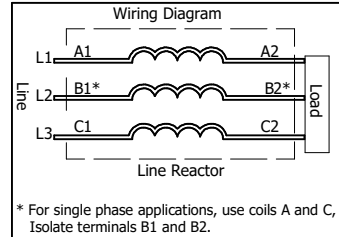
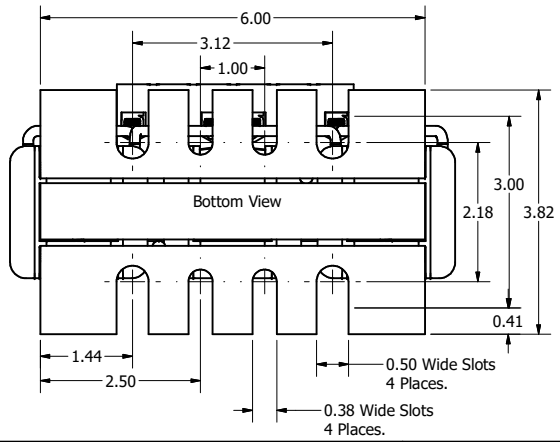
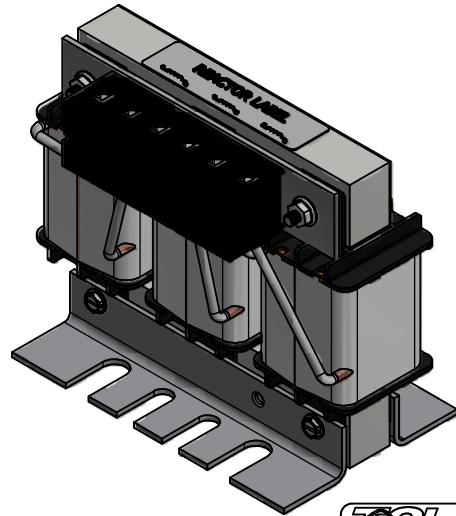
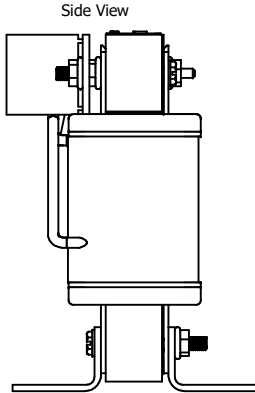
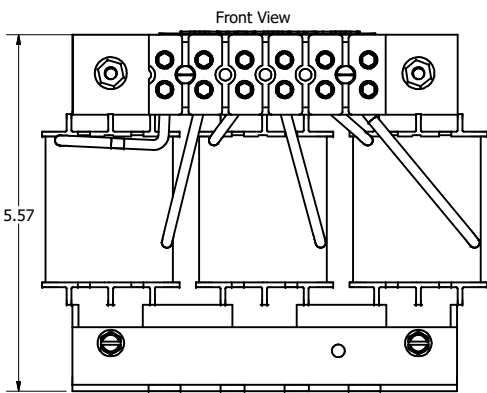

208/240 Rated Voltage, 600 Max Voltage, High Z, Impedance.

Part Number	Horsepower (HP)	Motor Amps (A)	Maximum Amps (A)	Inductance (uH)	Weight (LBS)	Losses (W)
KDRULD21H	10	30.8	31	554	12	92
KDRULD22H	15	46.2	47	375	12	108

208/240 Rated Voltage, 600 Max Voltage, Low Z, Impedance.

Part Number	Horsepower (HP)	Motor Amps (A)	Maximum Amps (A)	Inductance (uH)	Weight (LBS)	Losses (W)
KDRULD25L	10	30.8	34	342	12	64
KDRULD24L	15	46.2	48	220	12	85
KDRULD26L	20	59.4	62	172	12	94

480 Rated Voltage, 600 Max Voltage, Low Z, Impedance.

Part Number	Horsepower (HP)	Motor Amps (A)	Maximum Amps (A)	Inductance (uH)	Weight (LBS)	Losses (W)
KDRULD1L	25	34	40	569	10	96
KDRULD2L	30	40	45	469	10	105

575 Rated Voltage, 600 Max Voltage, High Z, Impedance.

Part Number	Horsepower (HP)	Motor Amps (A)	Maximum Amps (A)	Inductance (uH)	Weight (LBS)	Losses (W)
KDRULD41H	20	22	23	2070	12	105

575 Rated Voltage, 600 Max Voltage, Low Z, Impedance.

Part Number	Horsepower (HP)	Motor Amps (A)	Maximum Amps (A)	Inductance (uH)	Weight (LBS)	Losses (W)
KDRULD42L	30	32	32	853	12	106

480 Rated Voltage, 600 Max Voltage, Output

Part Number	Horsepower (HP)	Motor Amps (A)	Maximum Amps (A)	Inductance (uH)	Weight (LBS)	Losses (W)
KDRULD1P	15	21	21	548	10	30
KDRULD2P	20	27	27	444	10	43
KDRULD3P	25	35	35	305	12	55
KDRULD4P	30	45	45	262	12	59

575 Rated Voltage, 600 Max Voltage, Output

Part Number	Horsepower (HP)	Motor Amps (A)	Maximum Amps (A)	Inductance (uH)	Weight (LBS)	Losses (W)
KDRULD31P	15	15	17	643	10	27
KDRULD32P	20	20	22	439	10	43
KDRULD35P	25	25	27	460	10	43
KDRULD33P	30	30	32	329	10	55
KDRULD34P	40	40	41	256	12	59

TCL (800) 824-8282 transcoil.com
 TCL, LLC Germantown, WI, USA. transcoil.com 800-824-8282
 KDRUL Drive Reactor
 KDRUL — Motor Amps —
 3PH, 50/60Hz, —V Rated, 600V Max, —A Max
 40C Amb Max, 150C Rise, RoHS
 Term Torque — lb-in

- Notes:
- UL file number: cULus Listed File E116124.
 - KDR Drive Reactors Comply With The Thermal and Altitude Standards Set Forth by NEMA ST20-1992.
 - KDR IOM Manual Part Number 30895
 - NEC Current For 208/240 Volts, Horsepower Based On 208 Volts.
 - Material(s) Shall be RoHS Compliant
 - Customer Is Responsible For Installation To Meet All National And Local Electrical Codes.

NO	REVISION	DATE	BY	DATE	BY	TOLERANCES (EXCEPT AS NOTED)	SCALE	DATE	BY	DATE	BY
C	5694, D1L, D2L at Rev: C, Rest at B	8/18/2021	DSW			DECIMAL .XX ± .25 .XXX ± .10					
C	5694, KDRULD2L, Gap Updated	8/18/2021	DSW								
C	5694, KDRULD1L, Max Amps 50A to 40A	8/18/2021	DSW								
B	4686, TB Screw CHANGED to 1/8 Hex.	5/9/2019	DSW			FRACTIONAL ± 1/16					
A	Combined Drawings	1/22/2018	DSW			ANGULAR ± 1°					

TOLERANCES (EXCEPT AS NOTED)
 DECIMAL
 .XX ± .25
 .XXX ± .10
 FRACTIONAL
 ± 1/16
 ANGULAR
 ± 1°

DWG. BY: DSW DATE: 1/22/2018 107513-2DG
 SCALE: 1/1.5 DRAWN BY: [Signature] SHEET: 1 OF 1