

UNIT SPECIFICATIONS:					
KVAR	HARMONIC	VOLT	HZ	PHASE	HP
180	5TH	600	60	3	600
ENCLOSURE		NEMA 1			
APPROX.WT. LBS.		1400			

SYMBOL	TCI PART NUMBER
LR	KDRY42T
TR	KTR180C65HG
CAP1- 9 (20 KVAR)	KCAP20C6B
XFMR.	25292
Fu1a;2a;3a	13232
Fu4,6	24390
Fu5	23977

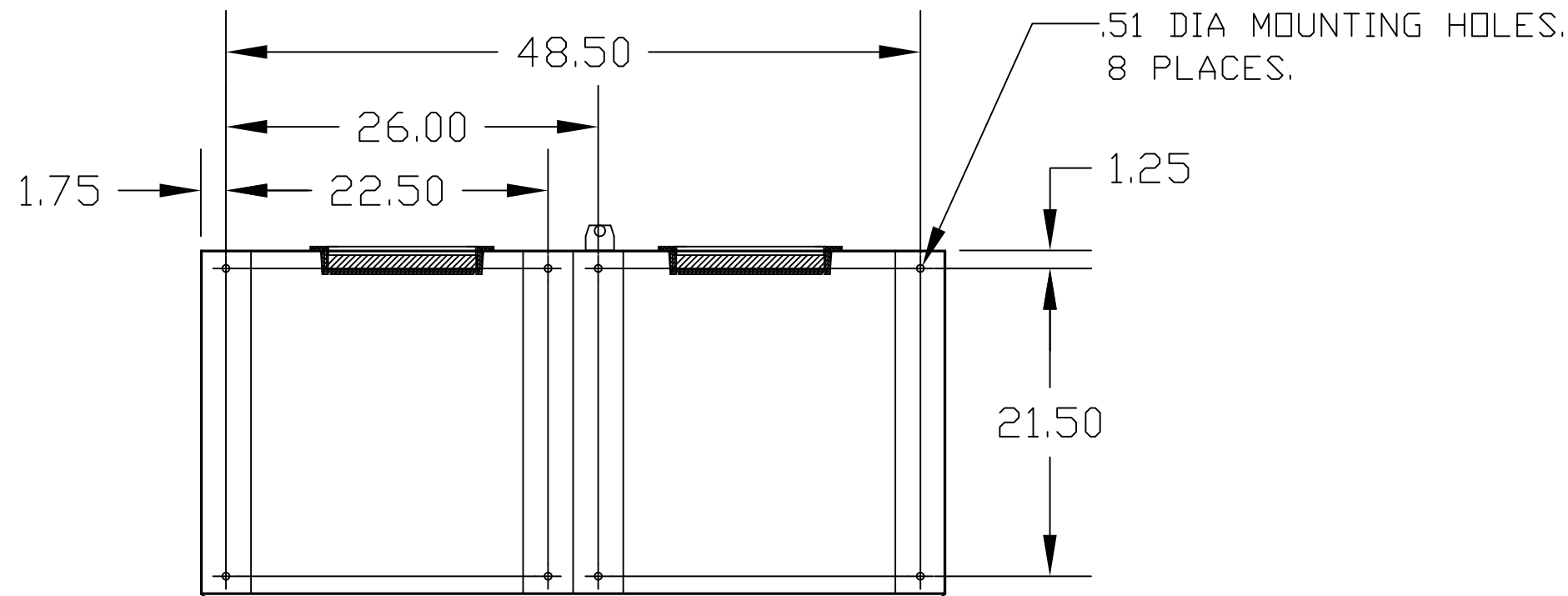
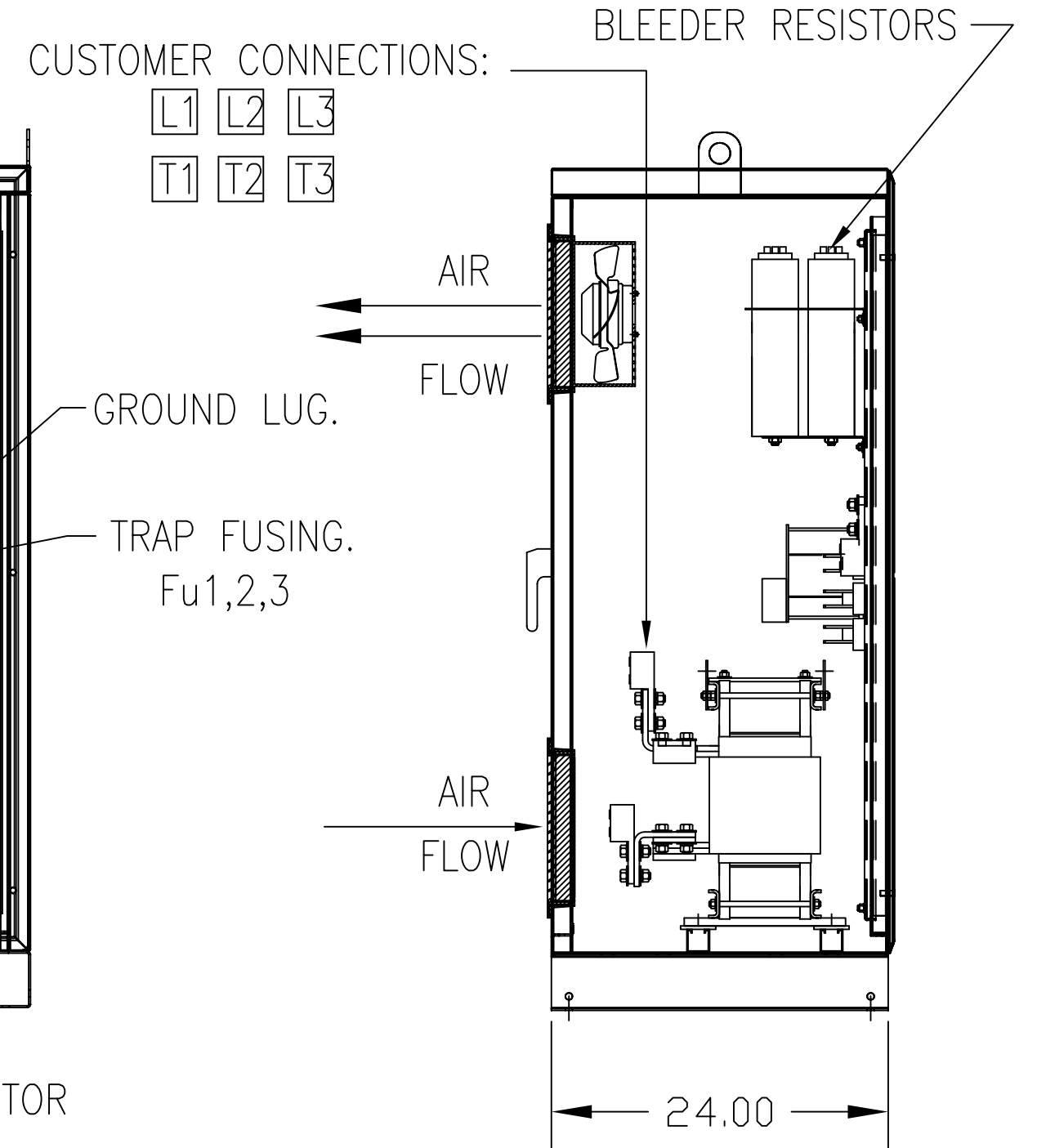
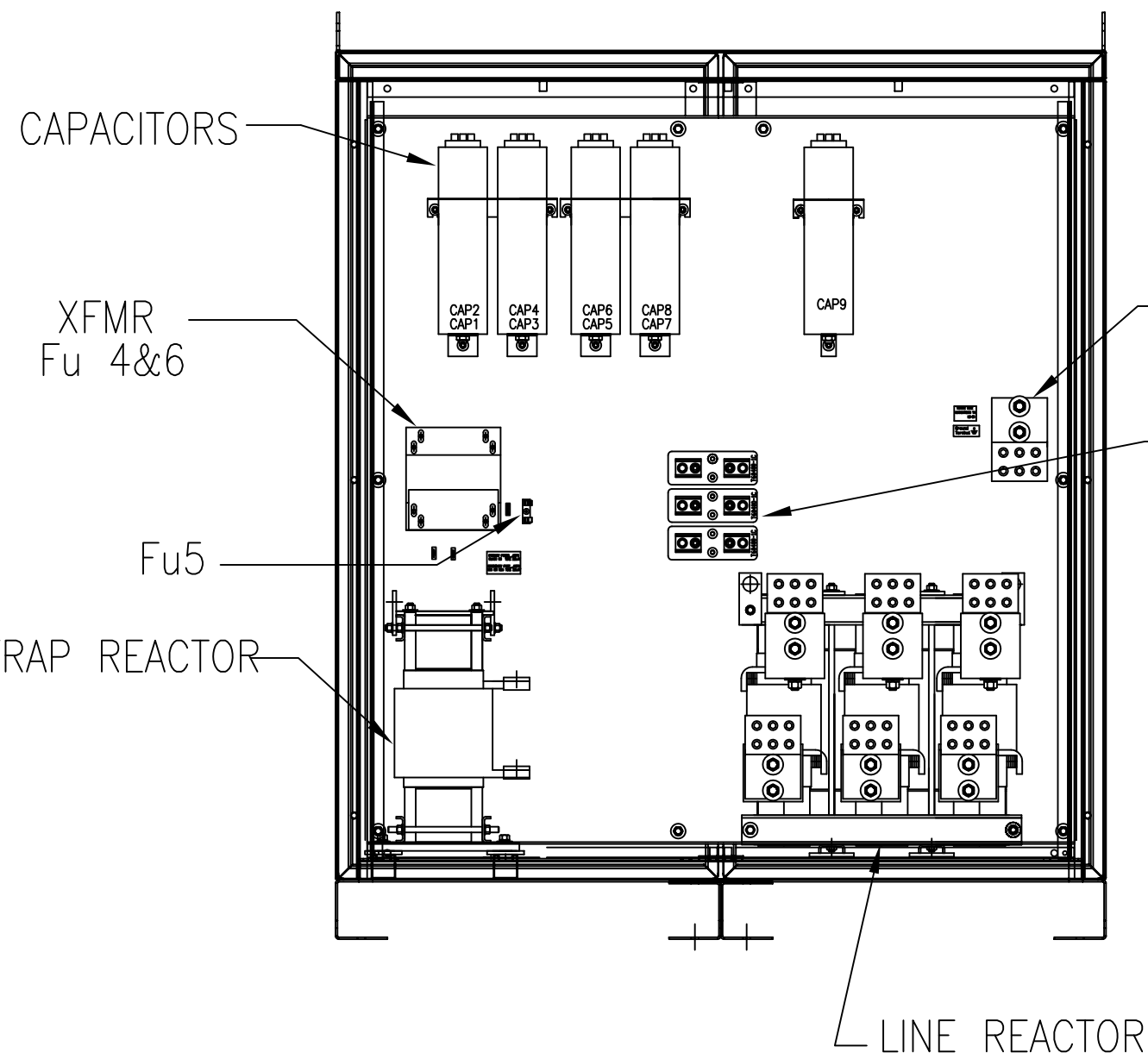
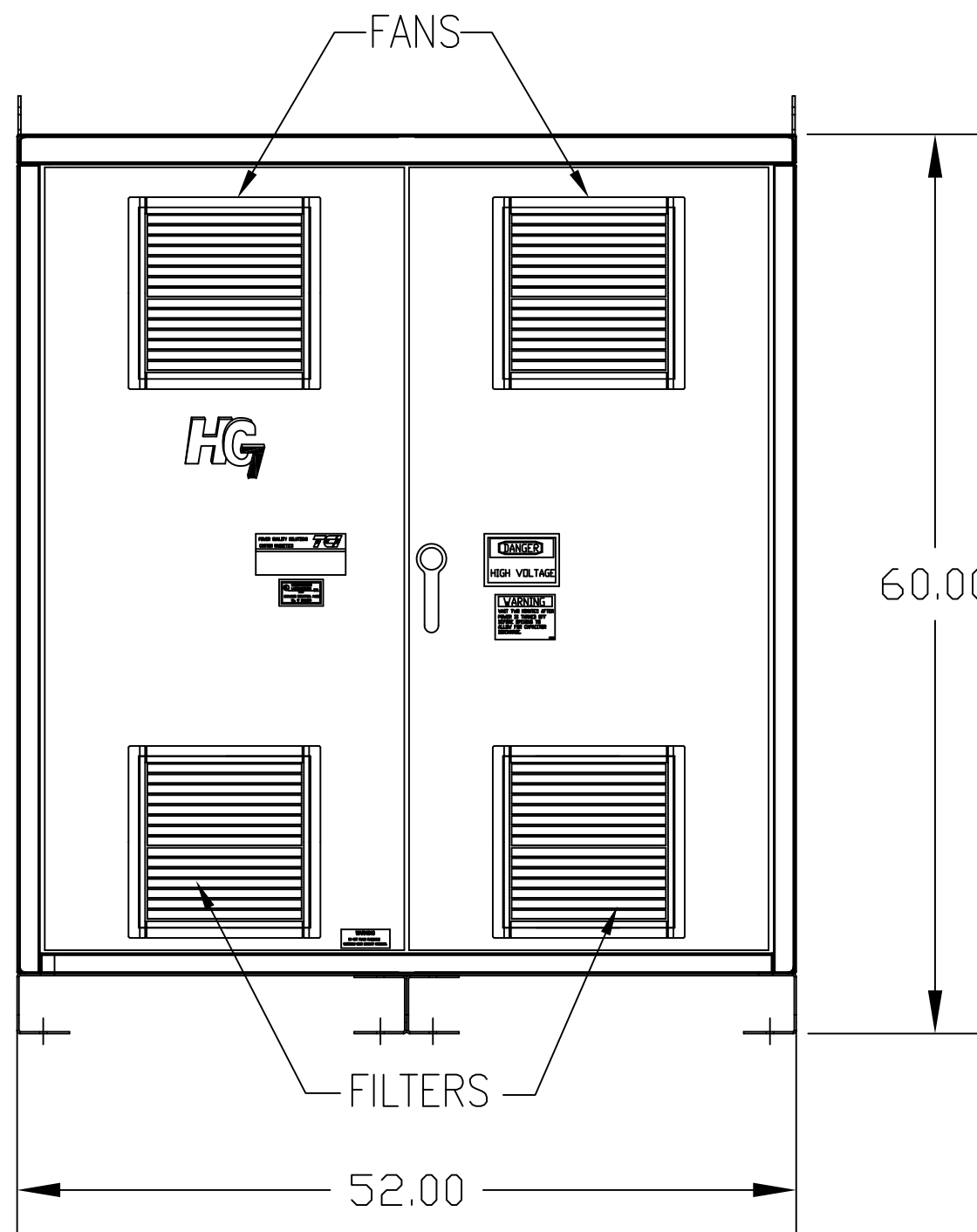

FOR SCHEMATIC SEE 25116

CUSTOMER IS RESPONSIBLE FOR INSTALLATION TO MEET ALL NATIONAL AND LOCAL ELECTRICAL CODES

CUSTOMER CONNECTIONS:  
WIRE RANGE—THREE 600MCM-2  
TIGHTENING TORQUE 375 IN-LB.

GROUND LUG:  
WIRE RANGE—THREE 600MCM-2  
TIGHTENING TORQUE 375 IN-LB.

TCI, LLC CLAIMS PROPRIETARY RIGHTS IN THE MATERIAL HEREIN DISCLOSED. IT IS SUPPLIED WITHOUT PREJUDICE TO ANY PATENT RIGHTS OF TCI AND MAY NOT BE REPRODUCED OR USED TO MANUFACTURE ANYTHING SHOWN THEREIN WITHOUT WRITTEN PERMISSION FROM TCI.				TOLERANCES (EXCEPT AS NOTED):	W132 N10611 Grant Drive Germantown, WI 53022
				DECIMAL	
					.XX ±.03
					.XXX ±.01
	B	2786 REMOVE COLOR	11/14/11	DSW	FRACTIONAL ± 1/32
	A	2516, CAP WAS 18612	9/30/07	RJC	ANGULAR ± 1/2°
	NO	REVISION	DATE	BY	SCALE TO FIT
					SIZE C
					DWG. NO. 102701DG
					SHT.1 OF 1