

SEE 26824 FOR SCHEMATIC

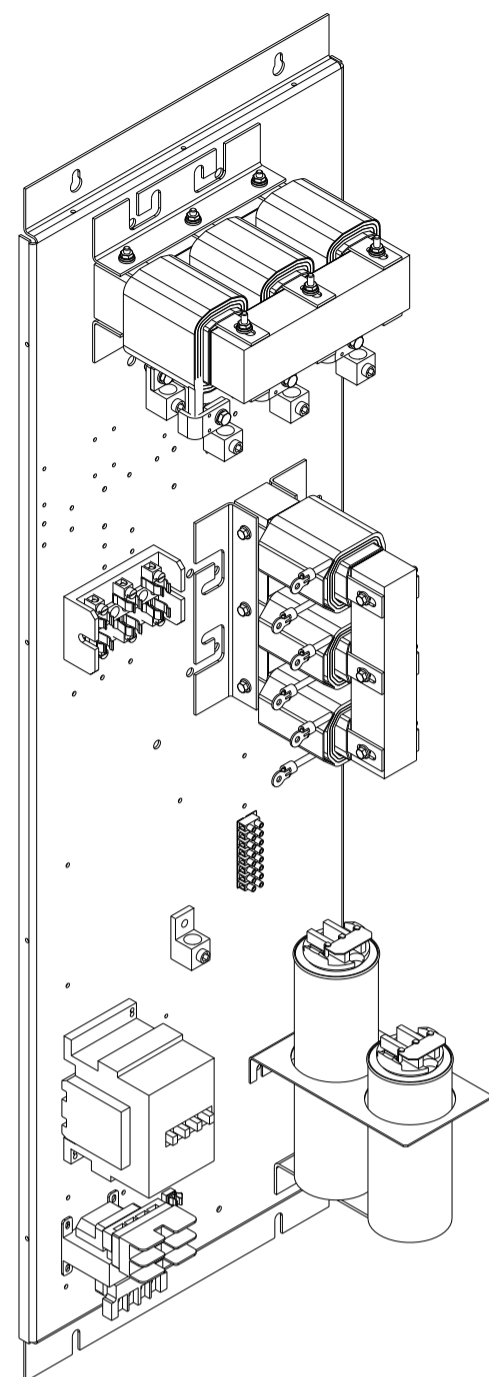

CUSTOMER CONNECTIONS:
WIRE RANGE-250MCM-6
TIGHTENING TORQUE 275 IN-LB.

GROUND LUG:
WIRE RANGE-250MCM-6
TIGHTENING TORQUE 275 IN-LB.

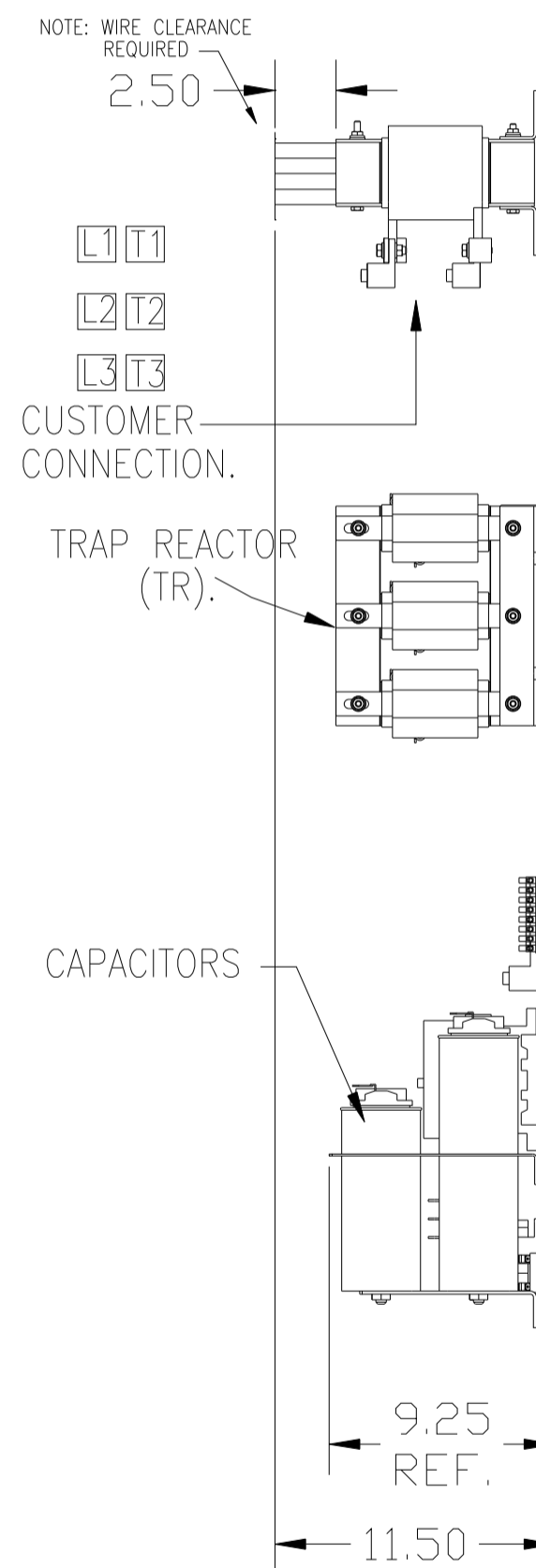
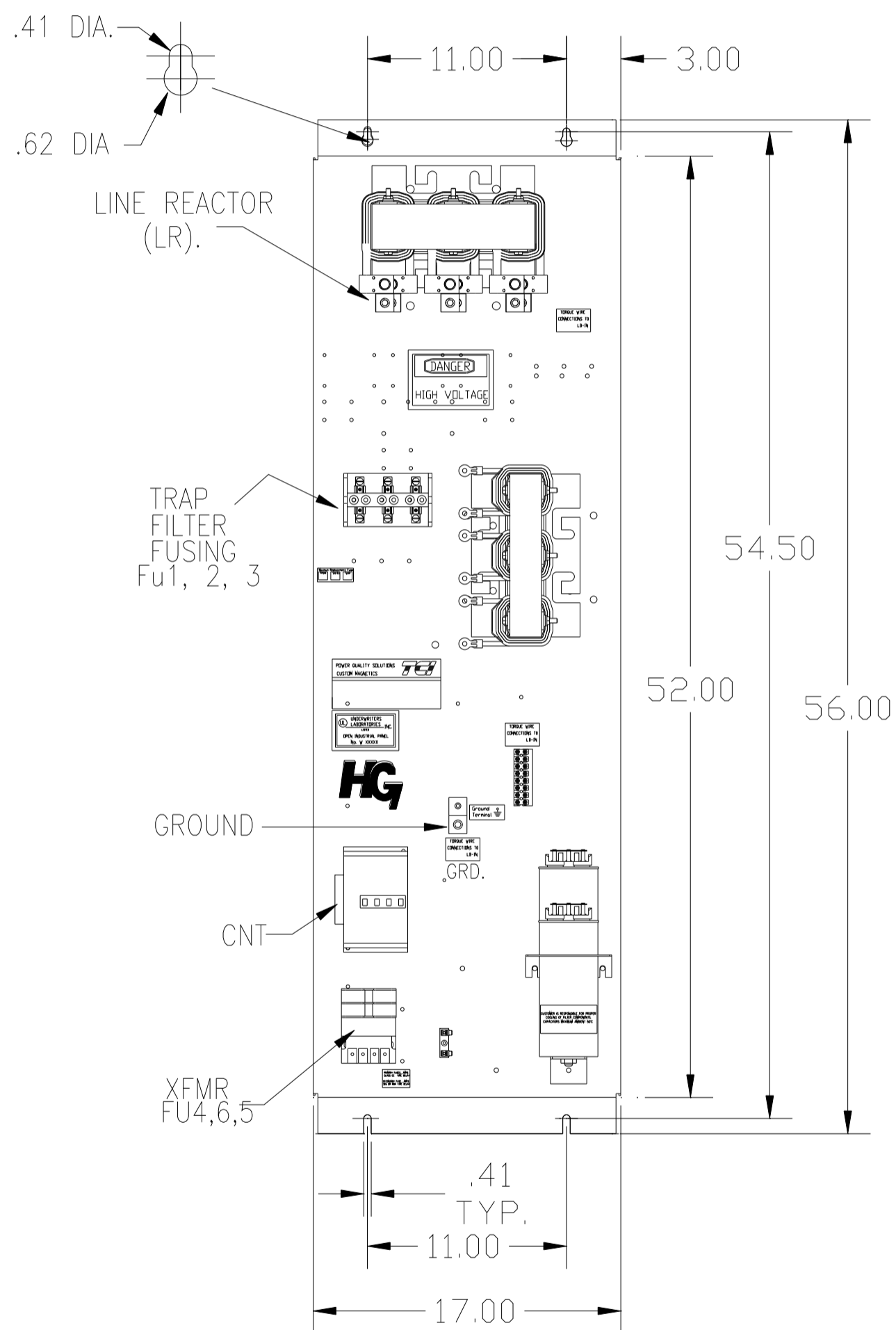

UNIT SPECIFICATIONS:				
KVAR HARMONIC	VOLT	HZ	PHASE	HP
15	5TH	240	60	3
ENCLOSURE	WHITE OPEN PANEL			
	WITH CONTACTOR			
APPROX.WT. LBS.	130			

SYMBOL	TCI PART NUMBER
LR	KDRG21T
TR	KTR15B65HG
CAP1 (10 KVAR)	KCAP10B6B
CAP2 (5 KVAR)	KCAP5B6B
XFMR.	23891
Fu1a;2a;3a	11006
Fu4,6	24073
Fu5	13364
CNT	19245

CUSTOMER IS RESPONSIBLE FOR PROPER COOLING OF FILTER COMPONENTS. CAPACITORS MAXIMUM AMBIENT 50°C.

CUSTOMER IS RESPONSIBLE FOR INSTALLATION TO MEET ALL NATIONAL AND LOCAL ELECTRICAL CODES.

				TOLERANCES (EXCEPT AS NOTED) DECIMAL	TCI 7878 N. 86th STREET MILWAUKEE, WI 53224
				.XX ± .03 .XXX ± .01	
				FRACTIONAL ± 1/32	HG50BW00STC, 50HP 240/3/60, OPEN, WITH CNT
				ANGULAR ± 1/2°	
NO	REVISION	DATE	BY	SCALE	DRN BY DSW DATE 10/10/08 DWG. NO. 103606DG SCALE TO SCALE AER. V.D. C SHT. 1 OF 1