

CUSTOMER IS RESPONSIBLE FOR INSTALLATION TO MEET ALL NATIONAL AND LOCAL ELECTRICAL CODES.

NOTE: USE ONLY HUBS OR FITTINGS THAT COMPLY WITH UL514B FOR TYPE 3R ENCLOSURES.

SEE DWG# 26757 FOR SCHEMATIC

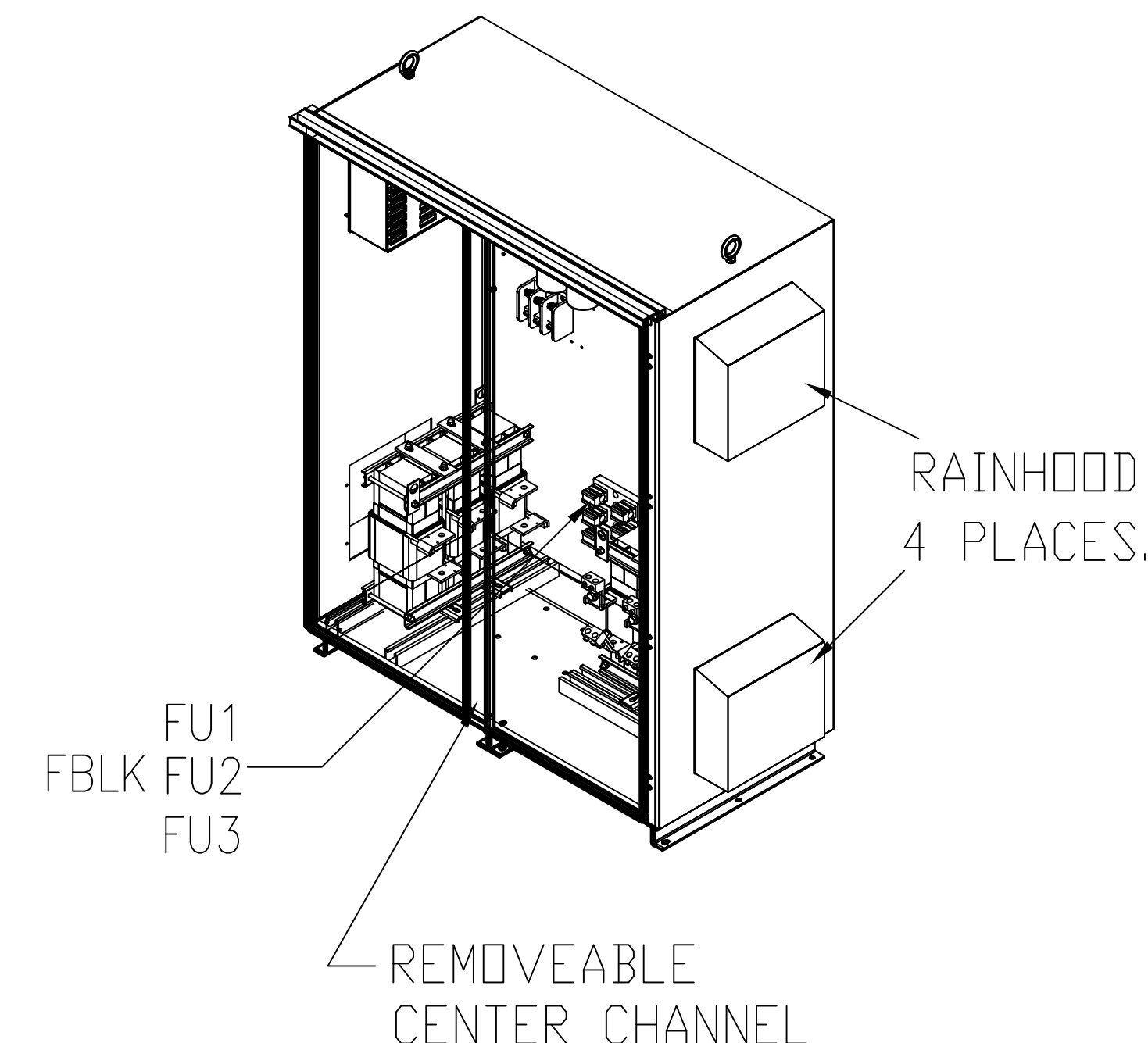
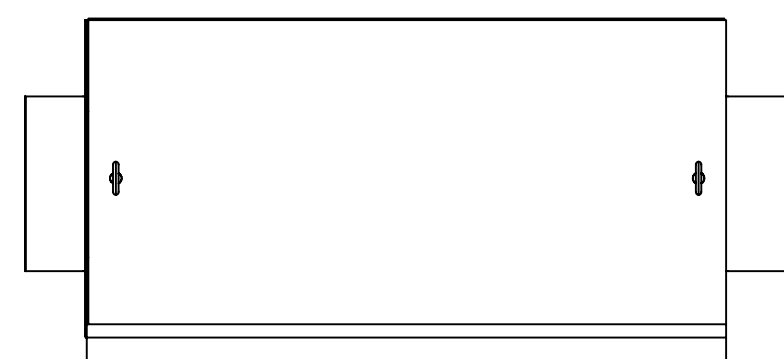
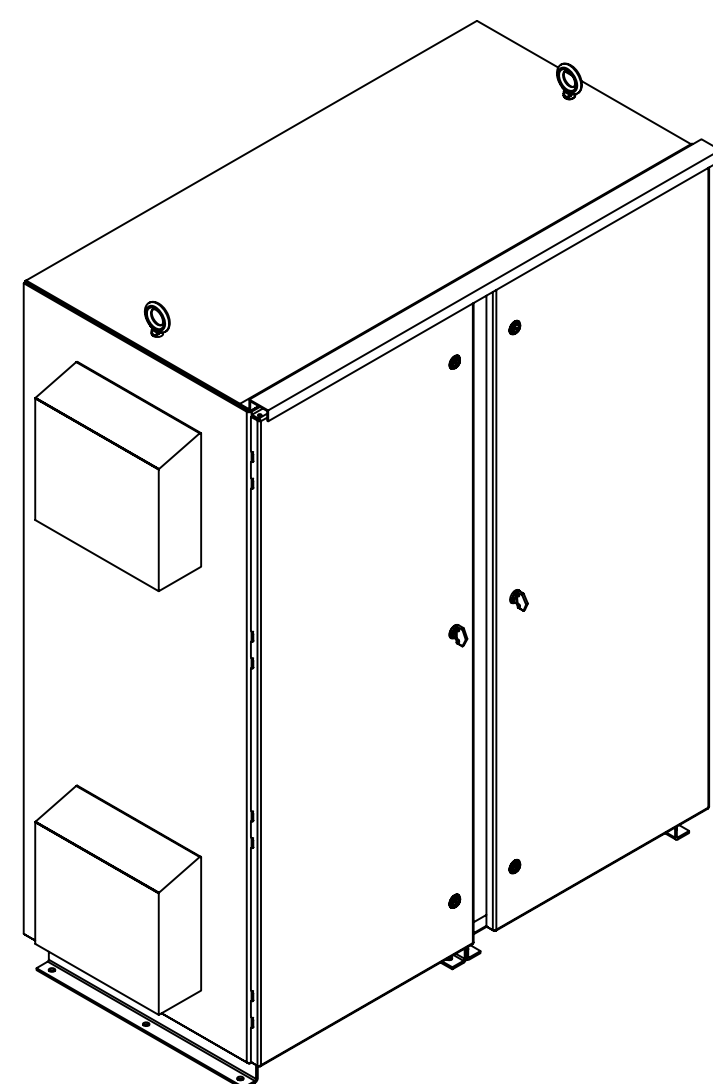

INSIDE DOOR

SIDE VIEW

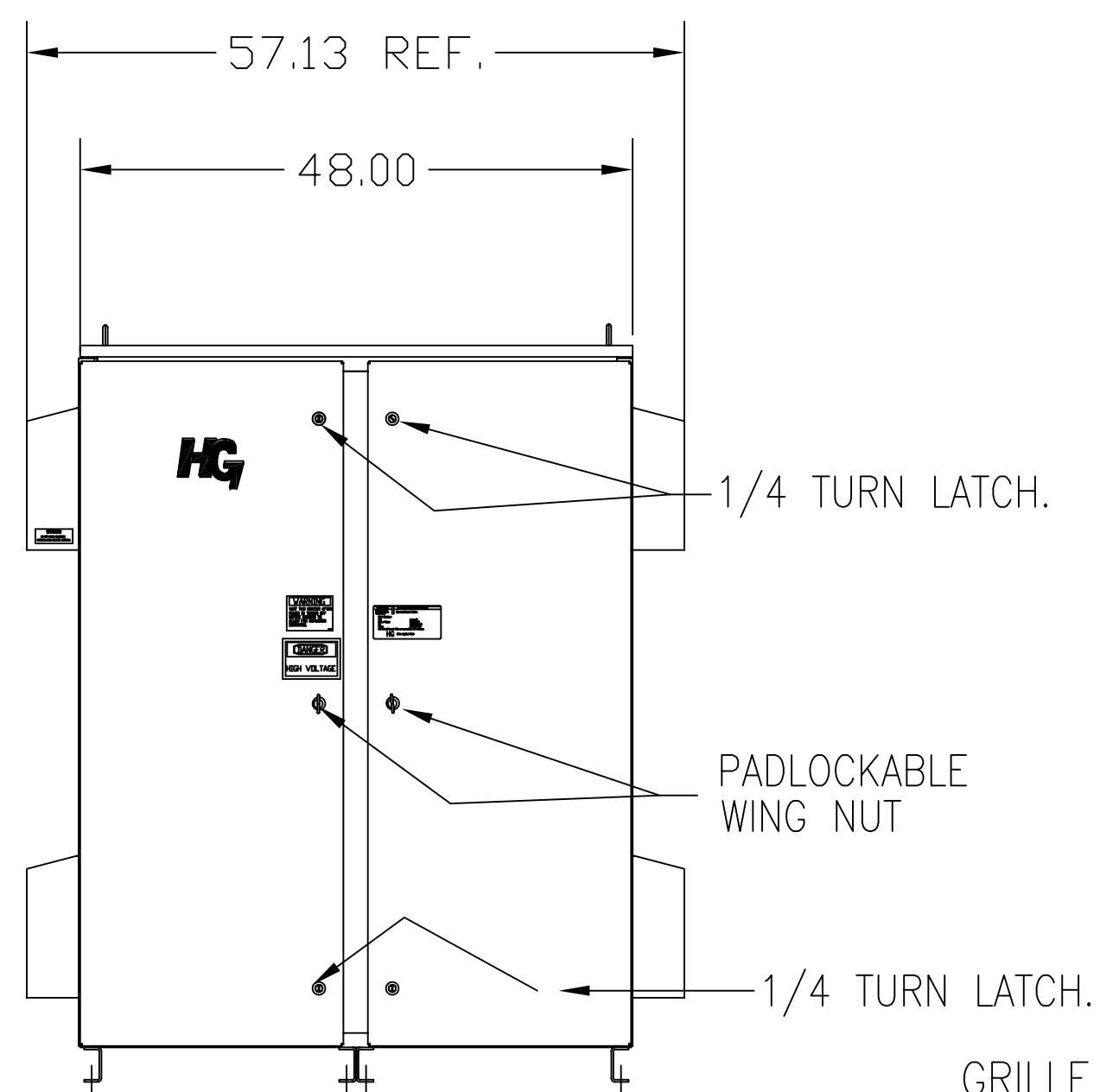
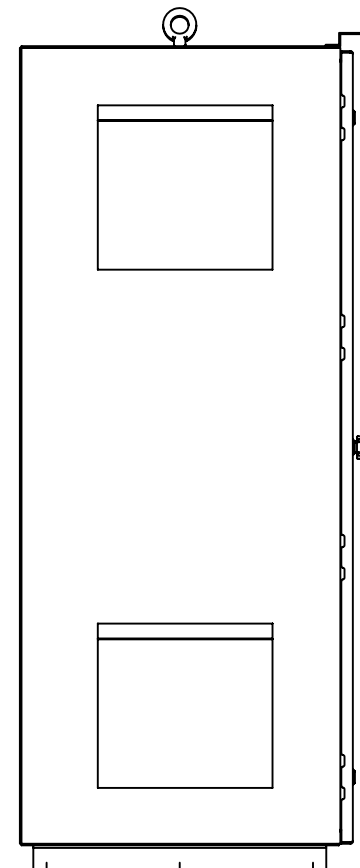
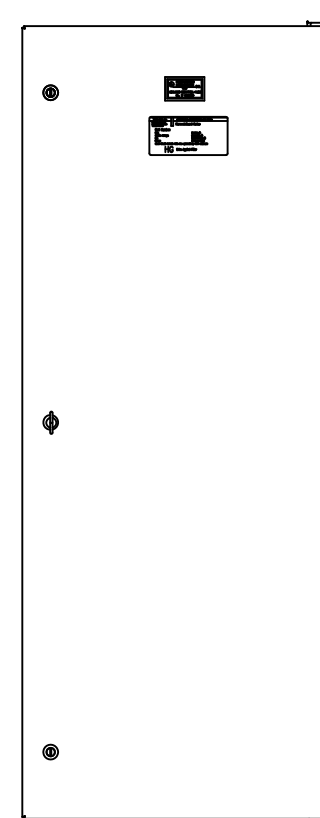

FRONT VIEW WITH DOORS.

FRONT VIEW WITHOUT DOORS

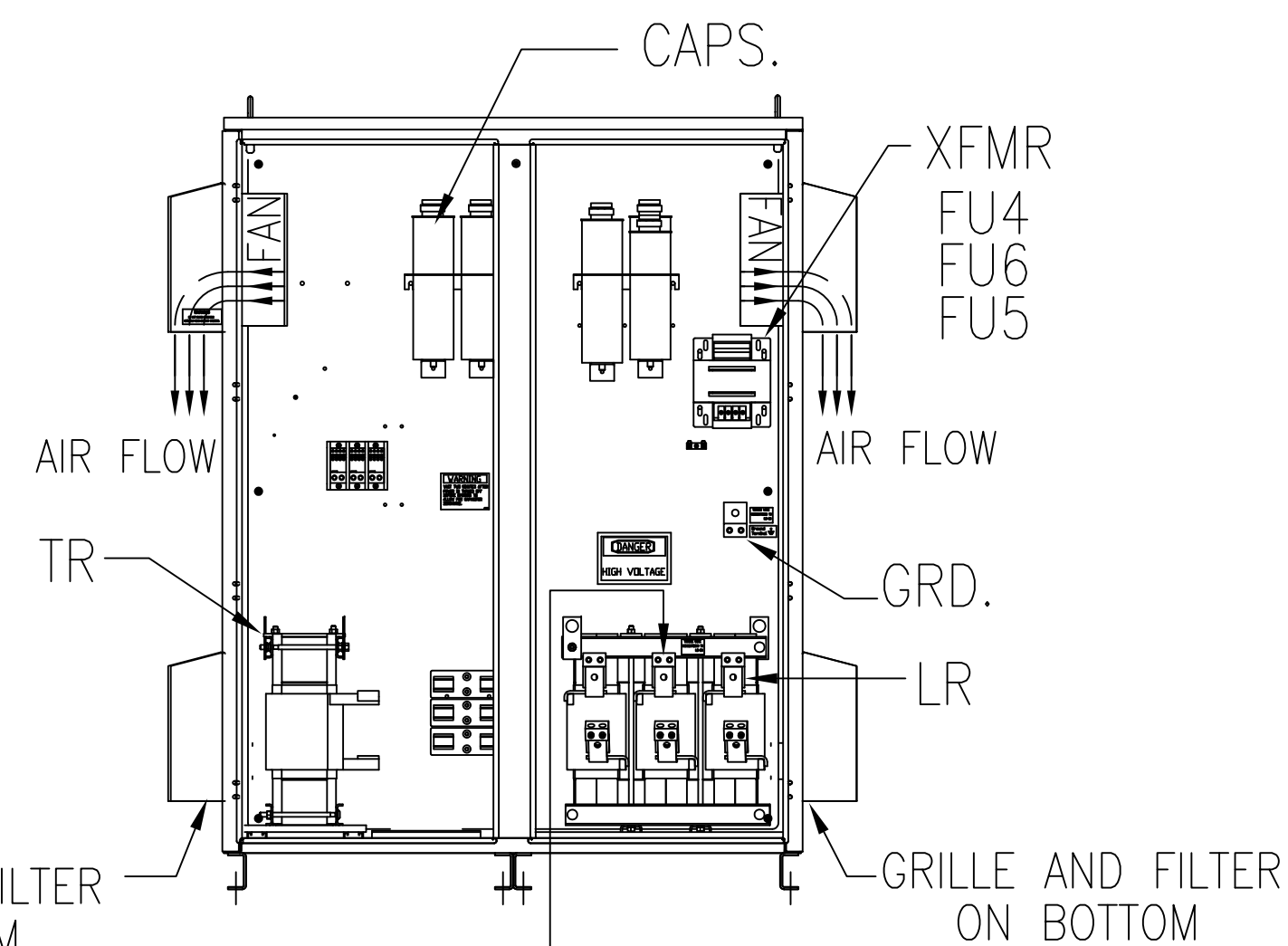

L1 L2 L3 T1 T2 T3

SUGGESTED CUSTOMER WIRE ENTRY AND EXIT LOCATION

.50 DIA HOLES 12 PLACES.

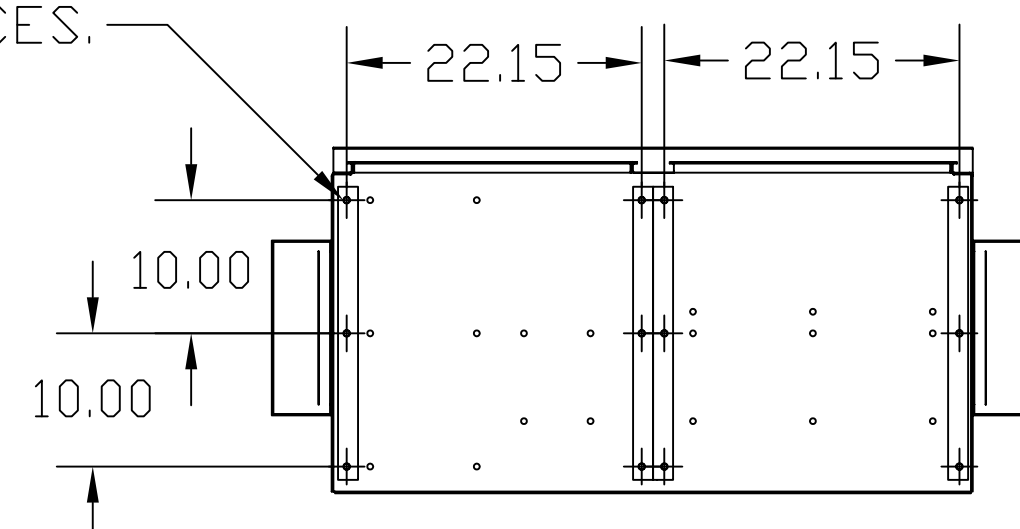

BOTTOM VIEW

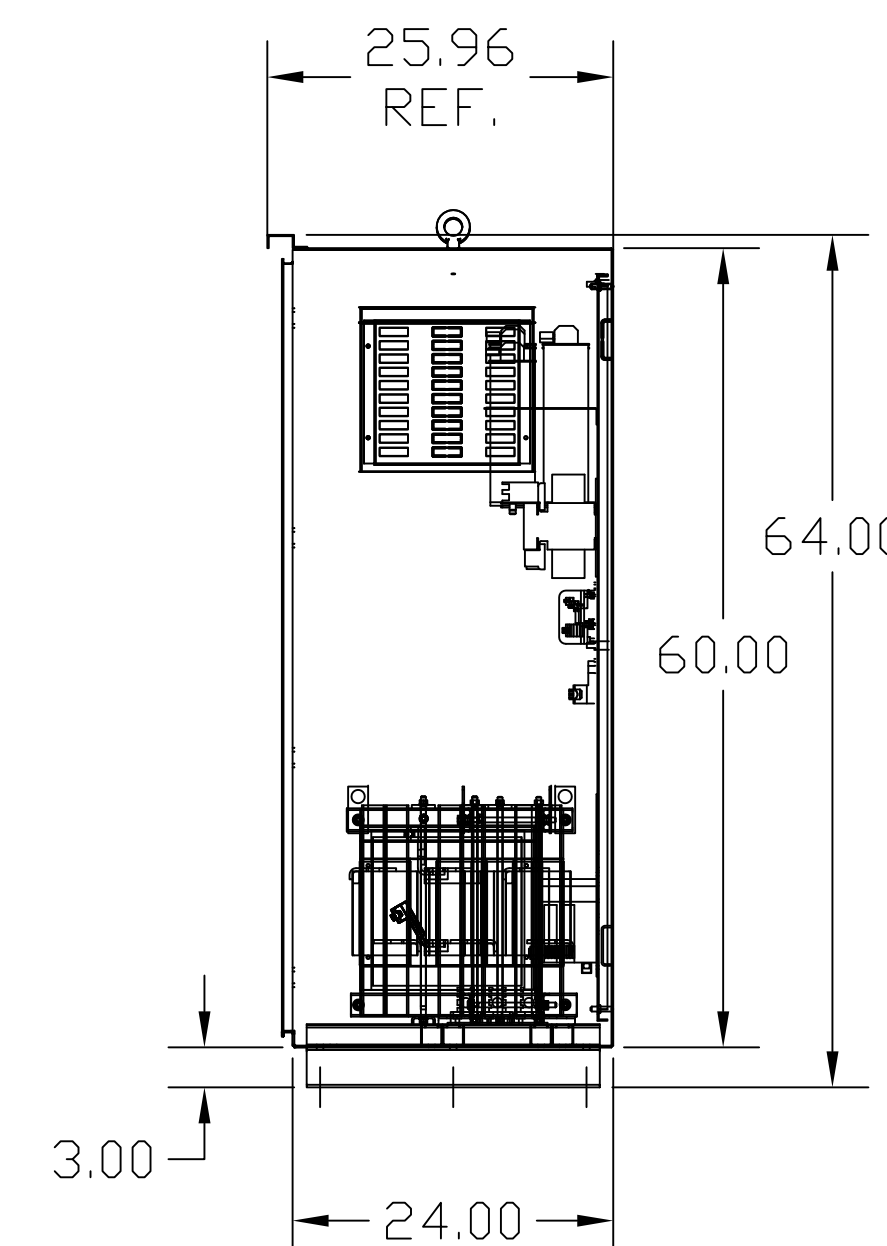

SIDE VIEW

SYMBOL	TCI PART NUMBER
LR	KDRX4TMD
TR	KTR135A65HG
CAP.1,2,3,4,5,6 (20 KVAR)	27609
CAP.7 (15 KVAR)	27608
XFMR.	24113
Fu1;2;3	13232
Fu4,6	14106
Fu5	24110

ALTERNATE	TCI PART NUMBER
CAP.1,2,3,4,5,6 (20 KVAR)	KCAP20A6B
CAP.7 (15 KVAR)	KCAP15A6B

**GROUND LUG:**  
WIRE RANGE-TWO 600MCM-2  
TIGHTENING TORQUE 500 IN-LB.

**CUSTOMER INPUT/OUTPUT CONNECTIONS:**  
WIRE RANGE-TWO 600MCM-2  
TIGHTENING TORQUE 500 IN-LB.

UNIT SPECIFICATIONS:					
KVAR	HARMONIC	VOLT	HZ	PHASE	HP
135	5TH	480	60	3	450
ENCLOSURE		TYPE 3R- COLOR, WHITE			
APPROX.WT. LBS		900			

<small>TCI, LLC CLAIMS PROPRIETARY RIGHTS IN THE MATERIAL HEREIN DISCLOSED. IT IS SUPPLIED WITHOUT PREJUDICE TO ANY PATENT RIGHTS OF TCI AND MAY NOT BE REPRODUCED OR USED TO MANUFACTURE ANYTHING SHOWN THEREIN WITHOUT WRITTEN PERMISSION FROM TCI.</small>				TOLERANCES (EXCEPT AS NOTED) DECIMAL	 <small>v132 N10611 Grant Drive Germantown, WI 53022</small>	
	C	2904 CHG TO ASC CAPS	3/7/13	DSW		.XX ±.12
	B	UPDATED REACTOR TO 135	8/28/11	RJC		.XXX±.06
		RVSD VIEW OF CAPS	8/28/11	RJC		FRACTIONAL ± 1/32
	Δ	2736 ADD DIST BLOCK	4/3/11	DSW	ANGULAR ± 1/2°	
NO	REVISION	DATE	BY	SCALE TO FIT	<small>DRN BY DSW DATE 9/18/08 DWG NO 103628DG</small> <small>SIZE D SHT.1 OF 1</small>	