

NOTES:

MATERIAL: #16GA (.059) STEEL
 FINISH:
 PRODUCT CODE - 312E
 COLOR - PEBBLE GRAY (BEIGE)
 POWDER TYPE - POLYESTER
 -POLYURETHANE

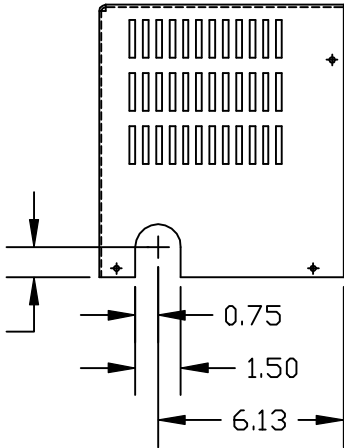

COVER
 TCI P/N 17136

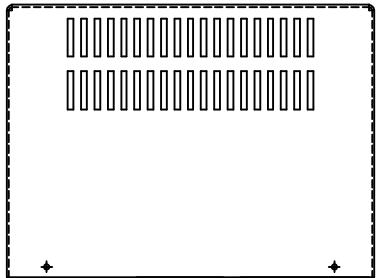
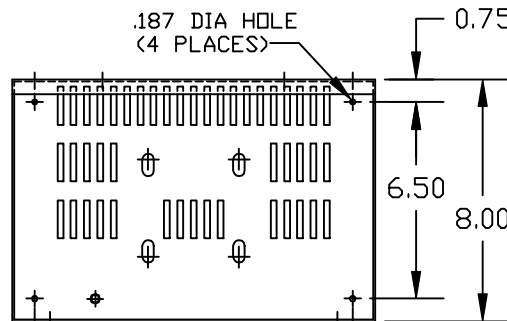

NOTES:
 MATERIAL: #16GA (.074) STEEL
 FINISH:
 PRODUCT CODE - 312E
 COLOR - PEBBLE GRAY (BEIGE)
 POWDER TYPE - POLYESTER
 -POLYURETHANE
 TOTAL ENCLOSURE WEIGHT: 12 LBS.

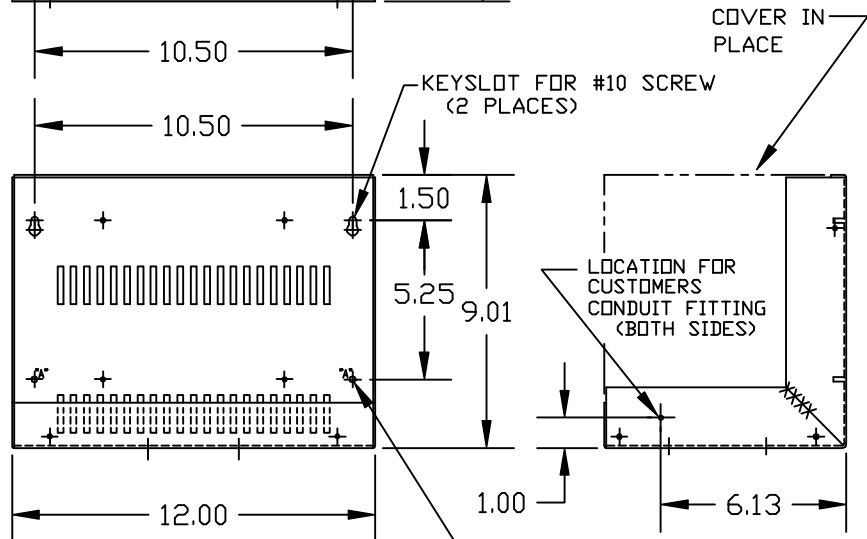

BASE
 TCI P/N 17135

				TOLERANCES EXCEPT AS NOTED:		7878 N. 86th STREET MILWAUKEE, WI 53224	
				DECIMAL			
				.XX ± .01		KLC CABINET SIZE 3 BASE AND COVER	
				.XXX ± .005			
				FRACTIONAL ± 1/32			
\triangle REDRAWN-NO REVS.		4/4/01	RJC	DRN. BY RJC SCALE 1/4"=1"		DATE 04-06-01 APPR'D B	
NO REVISION		DATE	BY	ANGULAR ± 1/2°		DWG. NO. C3 SHT. 1 OF 1	