

KMG305A

Res, Ass'y, .18 Ohm, 1012 Watt, P15211-22971

Hubbell Industrial Controls, Inc.

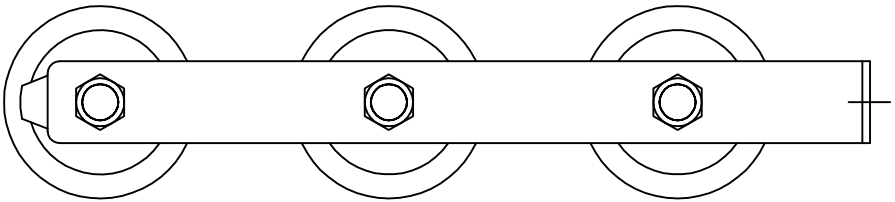
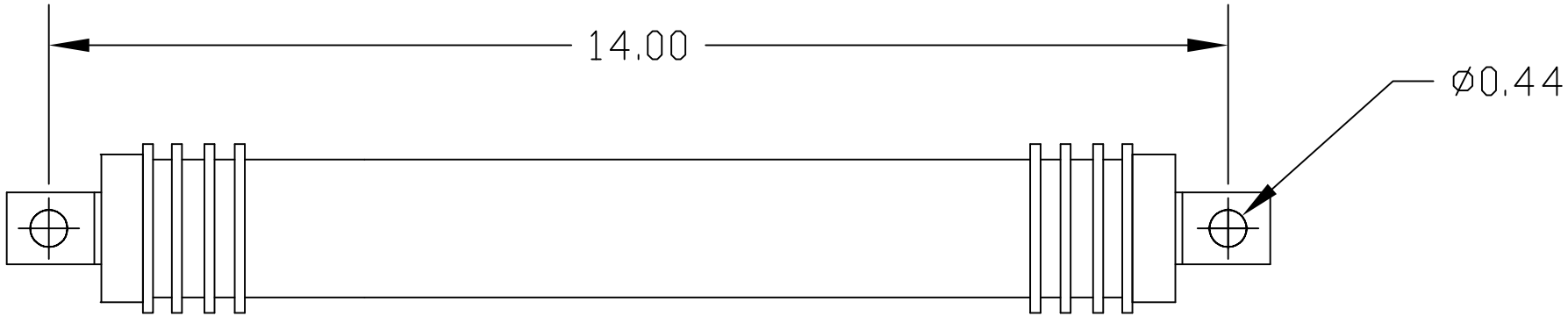
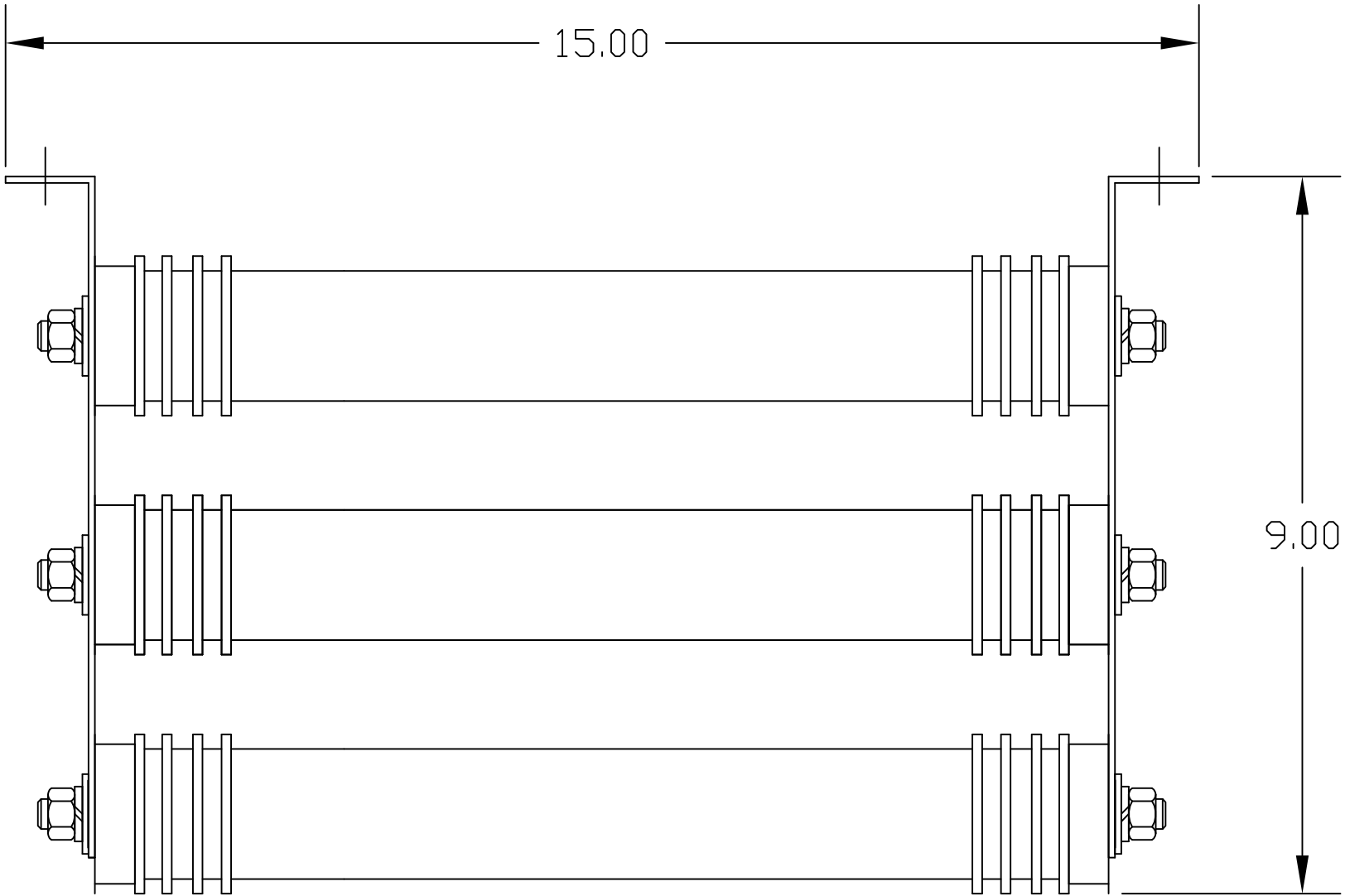

TCI, LLC CLAIMS PROPRIETARY RIGHTS IN THE MATERIAL HEREIN DISCLOSED. IT IS SUPPLIED WITHOUT PREJUDICE TO ANY PATENT RIGHTS OF TCI AND MAY NOT BE REPRODUCED OR USED TO MANUFACTURE ANYTHING SHOWN THEREIN WITHOUT WRITTEN PERMISSION FROM TCI.

NO	REVISION	DATE	BY
B	3223 REMOVE VISHAY RESISTOR	11/13/14	DSW
A	3150 ADD ALTERNATE TO DWG	9/22/14	DSW

TOLERANCES (EXCEPT AS NOTED)	
DECIMAL	.XX ± .03 .XXX ± .01
FRACTIONAL	± 1/32
ANGULAR	± 1/2°

TCI® W132 N10611 Grant Drive
Germantown, WI 53022

RESISTOR ASSEMBLY
.18 Ohm, 1012 Watt

DRN. BY	DSW	DATE	6/4/03	DWG. NO.	22971
SCALE	TO FIT	SIZE	B	SHT.1 OF1	