

KMG160C

Res, Ass'y, 0.40 Ohm, 524 Watt, P15211-22947  
 Hubbell Industrial Controls, Inc.

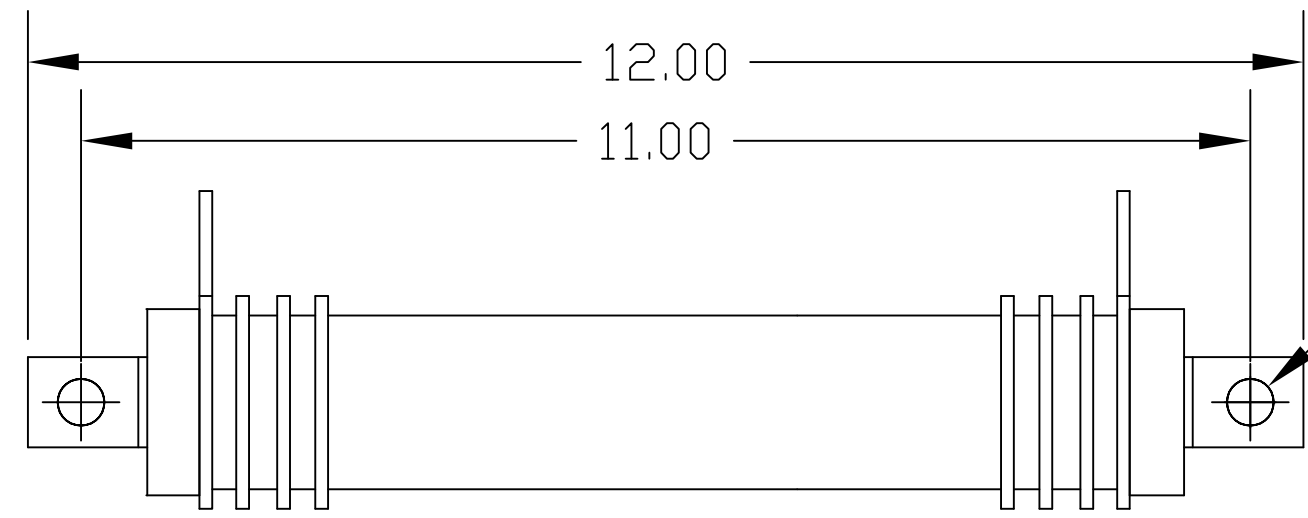

Ø0.44

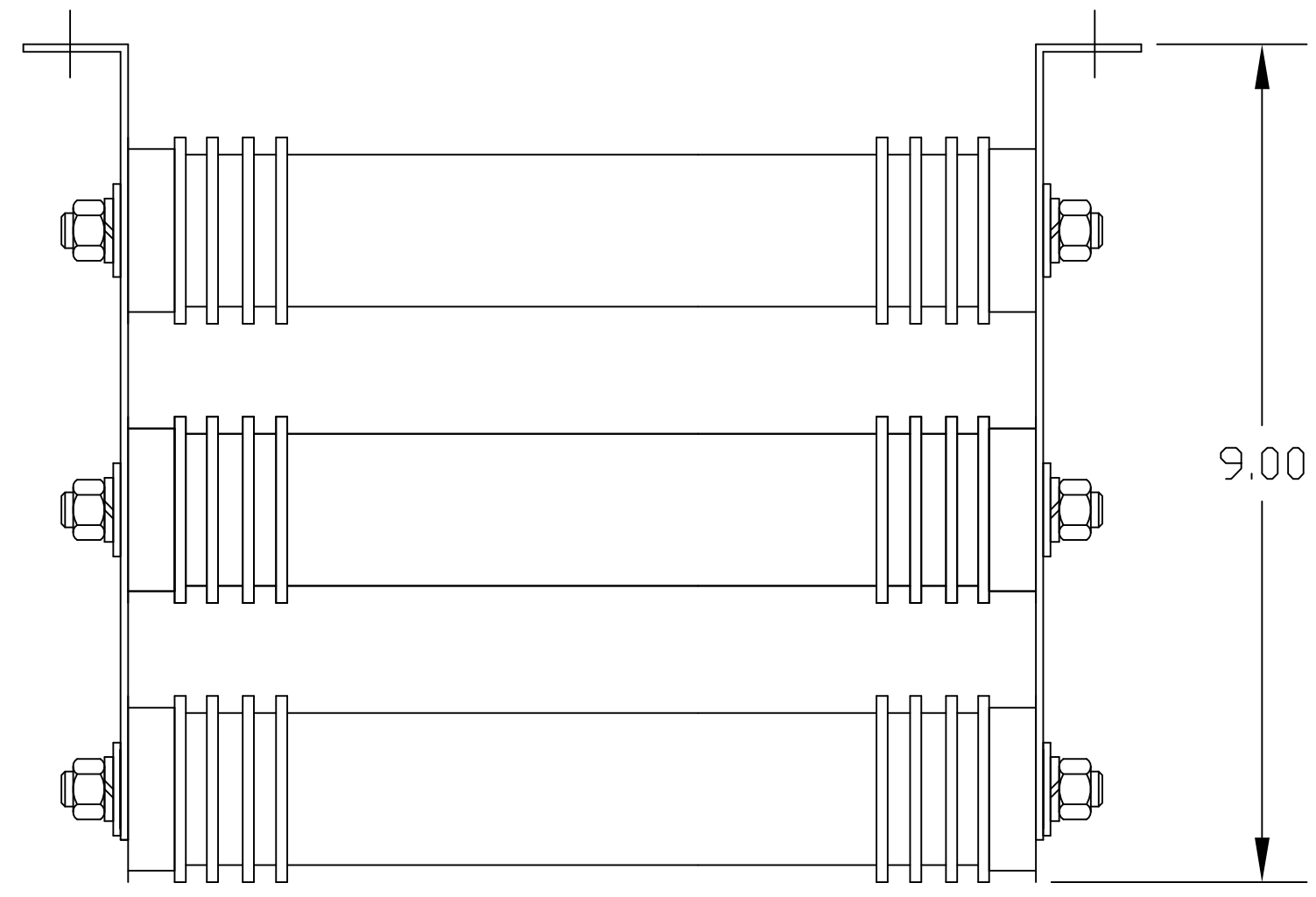
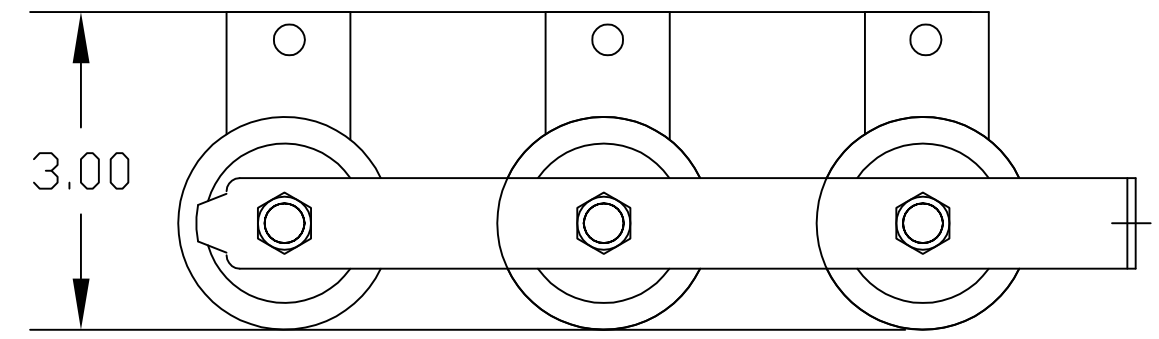

TCl, LLC CLAIMS  
 PROPRIETARY RIGHTS IN  
 THE MATERIAL HEREIN  
 DISCLOSED. IT IS  
 SUPPLIED WITHOUT  
 PREJUDICE TO ANY  
 PATENT RIGHTS OF TCl  
 AND MAY NOT BE  
 REPRODUCED OR USED  
 TO MANUFACTURE  
 ANYTHING SHOWN  
 THEREIN WITHOUT  
 WRITTEN PERMISSION  
 FROM TCl.

NO	REVISION	DATE	BY
B	3224 REMOVE VISHAY RESISTOR	11/13/14	DSW
A	3150 ADD ALTERNATE TO DWG	8/26/14	DSW

TOLERANCES (EXCEPT AS NOTED)	
DECIMAL	.XX ± .03 .XXX ± .01
FRACTIONAL	± 1/32
ANGULAR	± 1/2°

**TCl**® W132 N10611 Grant Drive  
 Germantown, WI 53022

**RESISTOR ASSEMBLY**  
 0.40 OHM

DRN. BY	DSW	DATE	11/12/12	DWG. NO.	22947
SCALE	TO FIT	SIZE	B	SHT.1 OF1	