

TCI Part Number	Rated Amps (A)	Rated Voltage (V)	Hz	---uH ±5%	Approx Weight (LBS)	Terminal Hole Size (Inches)
KTRMG110A	110	480	60	435	95	0.38

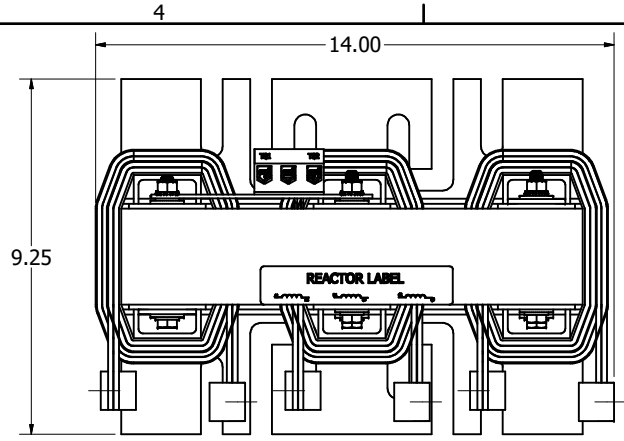

INSTALL THERMAL SWITCH AFTER REACTOR IS TREATED.

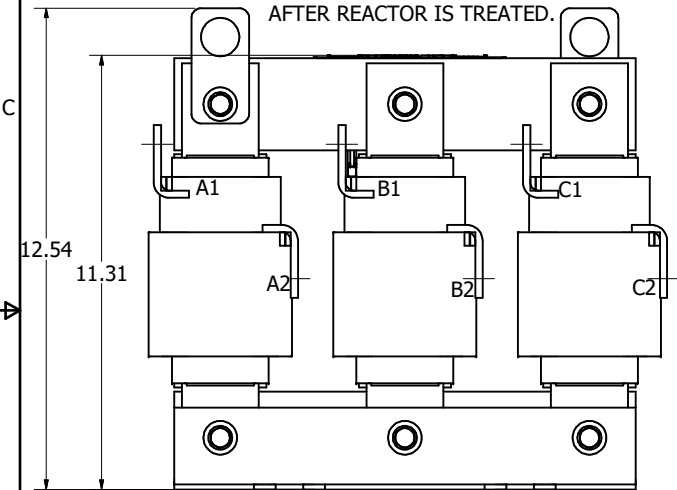

NOTE: MARKINGS A1,A2,B1,B2,C1,C2 ON COILS, ARE FOR REFERENCE ONLY.

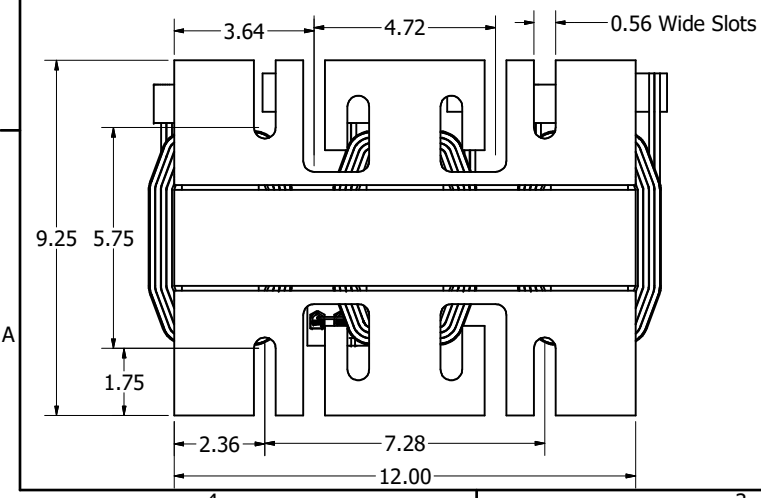
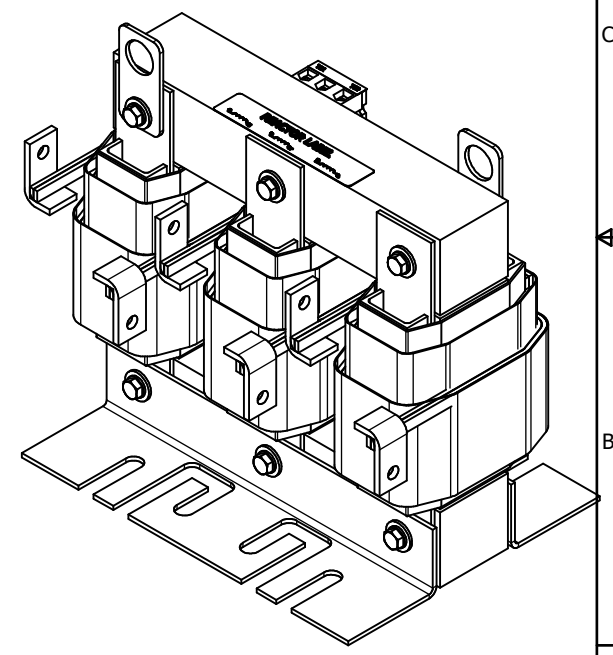
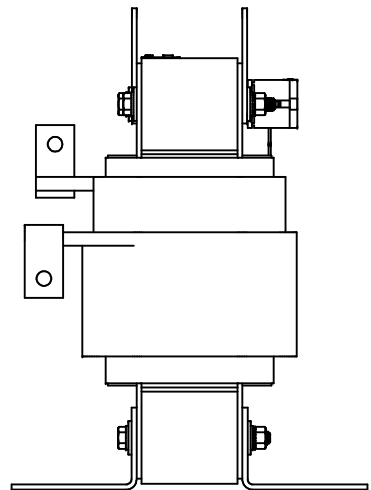

Thermal Switch Terminal Block

Wire Range: 18 AWG To 4 AWG.
Torque: 20 LB-IN (2.3 Nm)
Switch Opens on Temperature Rise
Contact Rating: 6A @ 120 VAC

Material(s) Shall be RoHS Compliant

THE INFORMATION AND DESIGNS CONTAINED IN THIS DRAWING ARE CONFIDENTIAL AND THE PROPRIETARY PROPERTY OF ALLIED MOTION TECHNOLOGIES INC. AND ITS SUBSIDIARIES. NEITHER THIS DESIGN NOR ANY INFORMATION CONTAINED IN THIS DRAWING MAY BE REPRODUCED OR DISCLOSED TO OTHERS WITHOUT THE EXPRESS WRITTEN CONSENT OF ALLIED MOTION TECHNOLOGIES INC. AND ITS SUBSIDIARIES.				TOLERANCES (EXCEPT AS NOTED)		 <small>W132N10611 (Rev 1) 11/16 Germantown, WI 53022</small> <small>© 2023 TCI, LLC</small> KTRMG110A Open Sinewave Inductor
				DECIMAL		
				.XX ± .25 .XXX ± .10		
				FRACTIONAL		
A	6300, Changed to Flag Terminals	6/6/2023	DSW	ANGULAR	± 1/32	DRN BY: DSW DATE: 6/6/2023 SCALE: 1/2.5 108083-3DG SHEET 1 OF 1
NO	REVISION	DATE	BY	ANGULAR	± 1°	