

(Customer Connections)
Markings On Coils
For Reference Only.

0.44 Wide x 0.75 Long Slots
4 Places

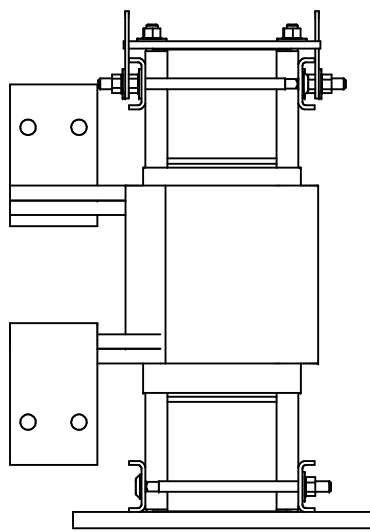
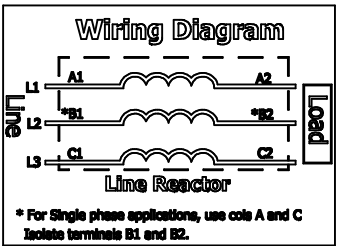

Notes:

1. KDR Lug Kits sold separately. Contact TCI.
2. UL file number: cULus Listed File E116124.
3. KDR Drive Reactors Comply With The Thermal and Altitude Standards Set Forth by NEMA ST20-1992.
4. KDR IOM Manual Part Number 30895
5. Material(s) Shall be RoHS Compliant
6. Customer Is Responsible For Installation To Meet All National And Local Electrical Codes.

TCI Part Number	Horsepower (HP)	Amps Max	uH +/- 5%	Approx Weight (LBS)	Available Lug Kit	Terminal Hole Size (Inches)
KDRX2H	800	960	32.5	300	SLK16	0.53

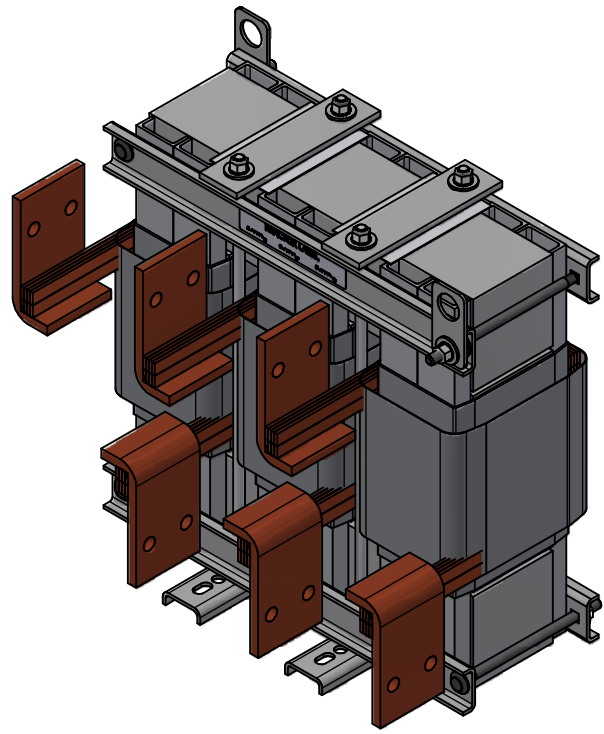

THE INFORMATION AND DESIGNS CONTAINED IN THIS DRAWING ARE CONFIDENTIAL AND THE PROPRIETARY PROPERTY OF ALLIED MOTION TECHNOLOGIES INC. AND ITS SUBSIDIARIES. NEITHER THIS DESIGN NOR ANY INFORMATION CONTAINED IN THIS DRAWING MAY BE REPRODUCED OR DISCLOSED TO OTHERS WITHOUT THE EXPRESS WRITTEN CONSENT OF ALLIED MOTION TECHNOLOGIES INC. AND ITS SUBSIDIARIES.				TOLERANCES (EXCEPT AS NOTED) DECIMAL .XX ± .25 .XXX ± .1 FRACTIONAL 1/32 ANGULAR ± 1°		TCI An Allied Motion Company KDRX2H 800HP, 480V, 960A DATE: 11/21/24 107539-14DG SHT 1 OF 1	
D	6874 M36 to M6 Core Leg	11/26/24	MY	DRN BY	SCALE	DATE	REV
NO	REVISION	DATE	BY				