

LABEL PLACED ON INSIDE WALL OF CABINET.

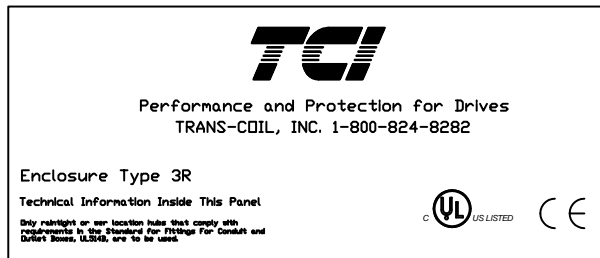

LABEL PLACED ON FRONT OF CABINET.

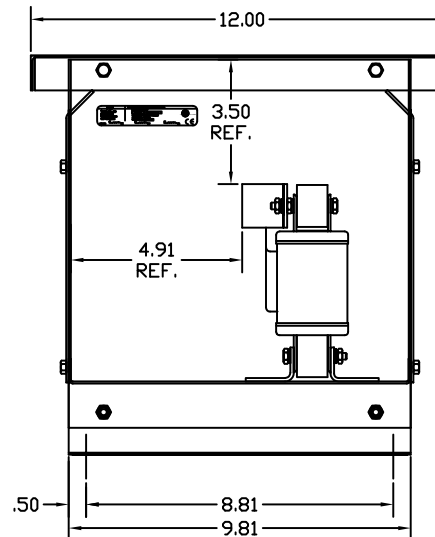
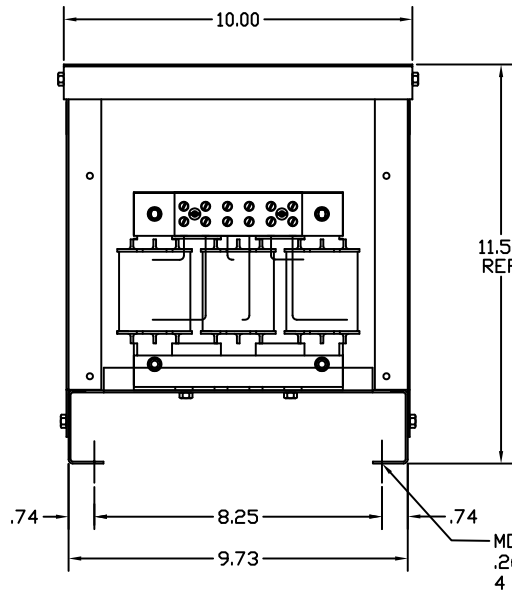

CATALOG NO	VOLTAGE	NEC MOTOR HP	NEC MOTOR CURRENT	WATTS LOSS	APPRX. WEIGHT-LBS	TORQUE (LB-IN)
KDRULD1LE3R	480	25	34	96	25.00	20
KDRULD2LE3R	480	30	40	105	25.00	20
KDRULD1PE3R	480	15	21	NOTE: 1	25.00	20
KDRULD2PE3R	480	20	27	NOTE: 1	25.00	20
KDRULD3PE3R	480	25	34	NOTE: 1	27.00	20
KDRULD4PE3R	480	30	40	NOTE: 1	27.00	20
KDRULD25LE3R	208/240	10	30.8	64	27.00	20
KDRULD24LE3R	208/240	15	46.2	85	27.00	20
KDRULD26LE3R	208/240	20	59.4	94	27.00	20
KDRULD21HE3R	208/240	10	30.8	91.8	27.00	20
KDRULD22HE3R	208/240	15	46.2	108	27.00	20
KDRULD42LE3R	575/600	30	32	106	27.00	20
KDRULD41HE3R	575/600	20	22	106	27.00	20
KDRULD31PE3R	575	15	17	NOTE: 1	25.00	20
KDRULD32PE3R	575	20	22	NOTE: 1	25.00	20
KDRULD35PE3R	575	25	27	NOTE: 1	25.00	20
KDRULD33PE3R	575	30	32	NOTE: 1	27.00	20
KDRULD34PE3R	575	40	41	NOTE: 1	27.00	20

NOTE 1: WATTS LOSS WILL VARY DUE TO FUNDAMENTAL FREQUENCY, CARRIER FREQUENCY AND OTHER SYSTEM CHARACTERISTICS. KDR DRIVE REACTORS COMPLY WITH THE THERMAL AND ALTITUDE STANDARDS SET FORTH BY NEMA ST20-1992..

NEC MOTOR CURRENTS SHOWN IN THE 208/240 VOLT CHART ARE BASED ON HORSEPOWER AT 208 VOLT. 575/600 VOLT CHART USE THE 575 VOLT CURRENT RATING.

BLOCK WIRE RANGE #18-#4 AWG
FOR REACTOR AND TIGHTENING TORQUE. 20 LB-IN



NOTE: A1, A2, B1, B2, C1, C2, MAKING'S ON TERMINAL BLOCK FOR REFERENCE ONLY.

CUSTOMER IS RESPONSIBLE FOR INSTALLATION TO MEET ALL NATIONAL AND LOCAL ELECTRICAL CODES.

FINISH:
VENDOR - LILLY POWDER COATINGS, INC.
PRODUCT CODE - 312E
COLOR - PEBBLE GRAY
POWDER TYPE - POLYESTER-POLYURETHANE
PAINT SUITABLE FOR OUTDOOR APPLICATION PER UL TYPE 3R AND APPLIED PER A UL ACCEPTED DTVV2 COATING PROGRAM.

TOLERANCES (EXCEPT AS NOTED)				TCI 7878 N. 86th STREET MILWAUKEE, WI 53224	
			DECIMAL	KDRUL, TYPE 3R, FRAME D	
		.XX ± .03			
		.XXX ± .01			
		FRACTIONAL		DRN BY DSW DATE 09/20/04 DWG NO. B KDRDE3R-1DG SCALE TO FIT APPRVD. SHT.1 OF1	
		± 1/32			
		ANGULAR			
NO	REVISION	DATE	BY	± 1/2°	