

NOTE: STUFFER SHEET MUST BE SHIPPED WITH EACH UNIT.

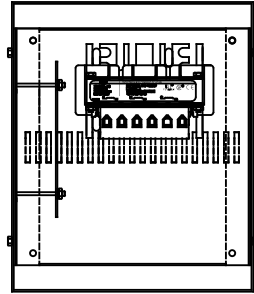

**PERFORMANCE AND PROTECTION FOR DRIVES**

Trans-Coil, Inc.  
Milwaukee, WI  
www.transcoil.com  
800-804-8888

KLCUL Output Filter  
KLCUL3R0020  
3PH, 60HZ, 480V Max, 18A Max  
Dwg # 103444DG Schematic # 23089  
Enclosure type: SE

UL LISTED

TCI TRANS-COIL, INC.  
MILWAUKEE, WISCONSIN  
800-804-8888  
FAX 414-387-4888

dV/dt GUARD  
KLC OUTPUT FILTER

LABEL DATA	CATALOG NO.	KLCUL18A3R1
	VOLTS	480
LABEL DATA	AMPS	18
	KLR PART NO.	KLR18BTB
	KLR BOARD NO.	24489
	APPROX. WT.-LBS	28
	BLOCK WIRE RANGE FOR REACTOR AND TIGHTENING TORQUE.	#18-#4 AWG 20 LB-IN

LABELS PLACED ON INSIDE WALL OF CABINET.

DRILL (2) .166 DIA HOLE FOR BOARD MOUNTING.

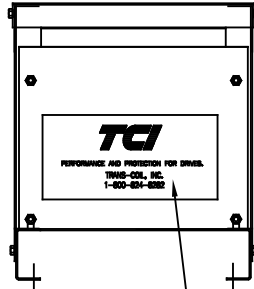
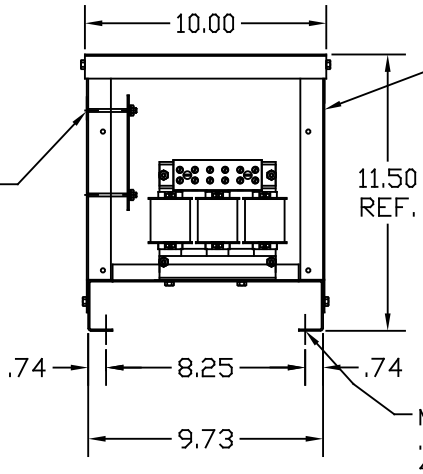

LABEL PLACED ON FRONT OF CABINET.

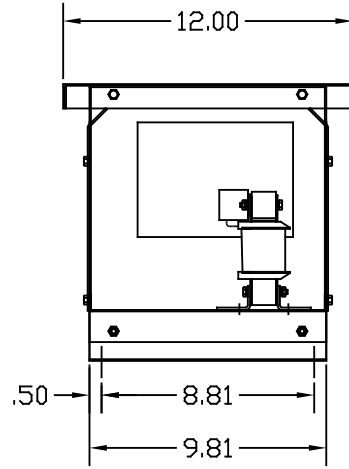

NOTE: CABINET FINISH: COLOR, BEIGE.

CUSTOMER IS RESPONSIBLE FOR INSTALLATION TO MEET ALL NATIONAL AND LOCAL ELECTRICAL CODES

NO	REVISION	DATE	BY	TOLERANCES (EXCEPT AS NOTED)
				DECIMAL
				.XX ± .03
				.XXX ± .01
				FRACTIONAL
				± 1/32
				ANGULAR
				± 1/2°

**TCI** 7878 N. 86th STREET  
MILWAUKEE, WI 53224

KLCUL3R ENCLOSED OUTPUT FILTER, 480V, KLCUL18A3R1

DRN BY DSW DATE 4/15/08 DWG NO. 103444DG  
SCALE 3/16"=1" APPRVD. B SH. 1 OF 1