

UNIT SPECIFICATIONS:						
KVAR	HARMONIC	VOLT	HZ	PHASE	HP	
3	5TH	480	60	3	7.5	
ENCLOSURE		NEMA 1 - BLACK COLOR				
OPTIONS		W/INDICATOR LIGHTS				
APPRX.WT. LBS.		100				

SYMBOL	TCI PART NUMBER
LR	KDRC1T
TR	KTR3A65HG
CAP. (5 KVAR)	KCAP3A6A
XFMR.	23891
Fu1, 2, 3	11262
Fu4,6	21270
Fu5	13364
CNT	12434

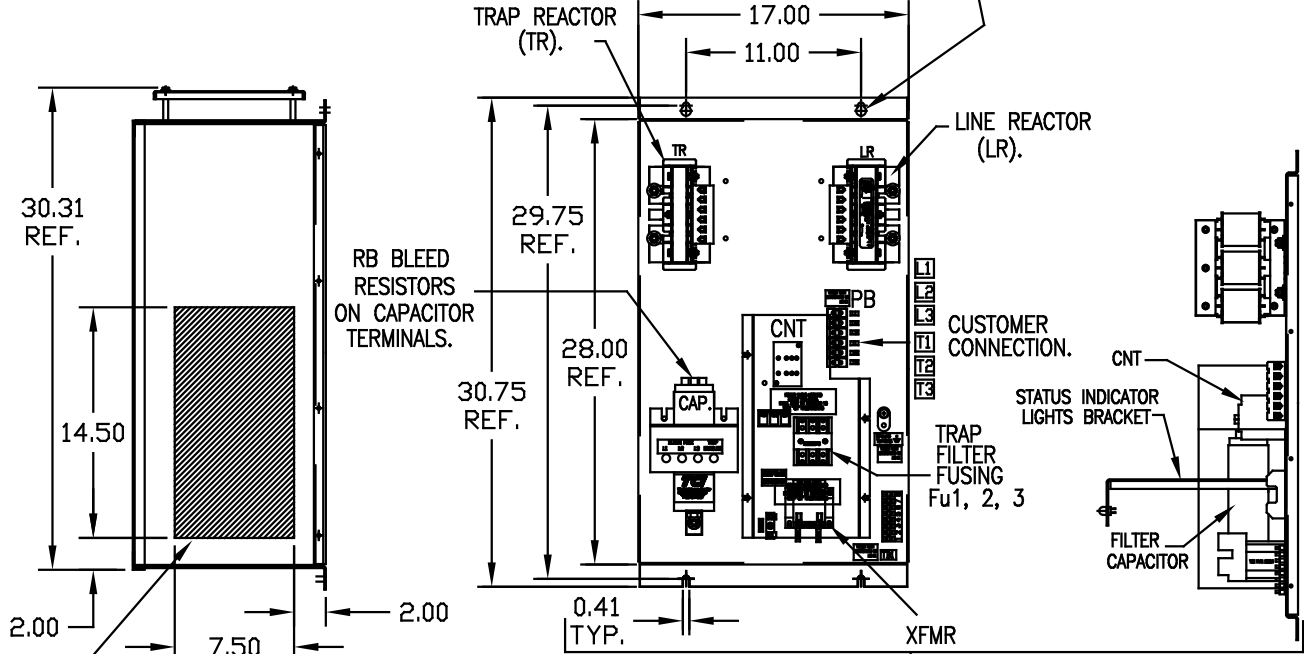
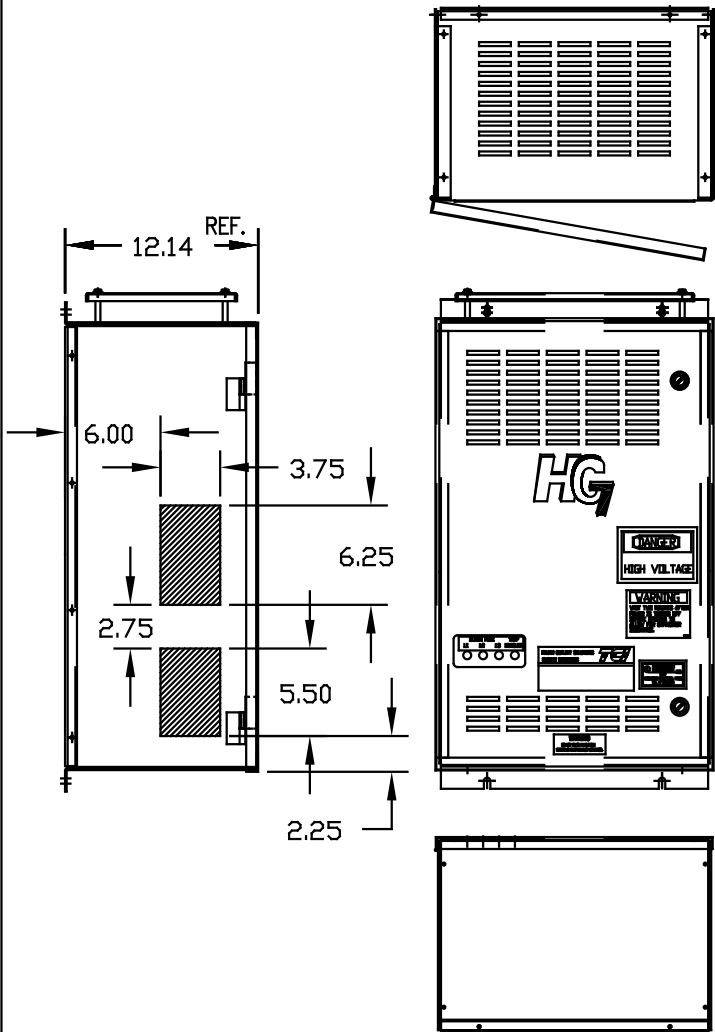
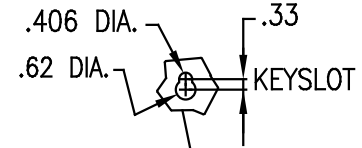

HATCHED AREAS ARE SUGGESTED CUSTOMER WIRE AND EXIT LOCATIONS

ENCLOSURE NOT SHOWN

SEE 25334-1 FOR WIRING CONNECTIONS
SEE 25334 FOR SCHEMATIC

CUSTOMER IS RESPONSIBLE FOR INSTALLATION TO MEET ALL NATIONAL AND LOCAL ELECTRICAL CODES.

PB-POWER INPUT BLOCK:
WIRE RANGE-#18 TO #4 AWG.
TIGHTENING TORQUE 20 IN.-LB.

GROUND LUG:
WIRE RANGE-1/0 TO #14 AWG.
TIGHTENING TORQUE 200 IN.-LB.

TOLERANCES EXCEPT AS NOTED:			
			DECIMAL
			.XX ±.03
			.XXX±.010
			FRACTIONAL ± 1/16
			ANGULAR ± 1/2°
△	2516, CAP WAS 16446	9/30/07	RJC
NO	REVISION	DATE	BY

TCI 7878 N. 86th STREET
MILWAUKEE, WI 53224

HG8AW01XM, HG7, W/ MONITOR
7.5HP, 480/3/60, TYPE1

DRN BY DSW DATE 10/06/05 DVG NL B 102850DG
SCALE 1/8"=1" APRVD

SHT.1 OF 1