

UNIT SPECIFICATIONS:					
KVAR	HARMONIC	VOLT	HZ	PHASE	HP
3	5TH	480	60	3	10
ENCLOSURE		NEMA 1 - BLACK COLOR			
OPTIONS		W/INDICATOR LIGHTS			
APPRX.WT. LBS.		100			

SYMBOL	TCI PART NUMBER
LR	KDREIT
TR	KTR3A65HG
CAP. (5 KVAR)	KCAP3A6A
XFMR.	23891
Fu1, 2, 3	11262
Fu4,6	21270
Fu5	13364
CNT	12434

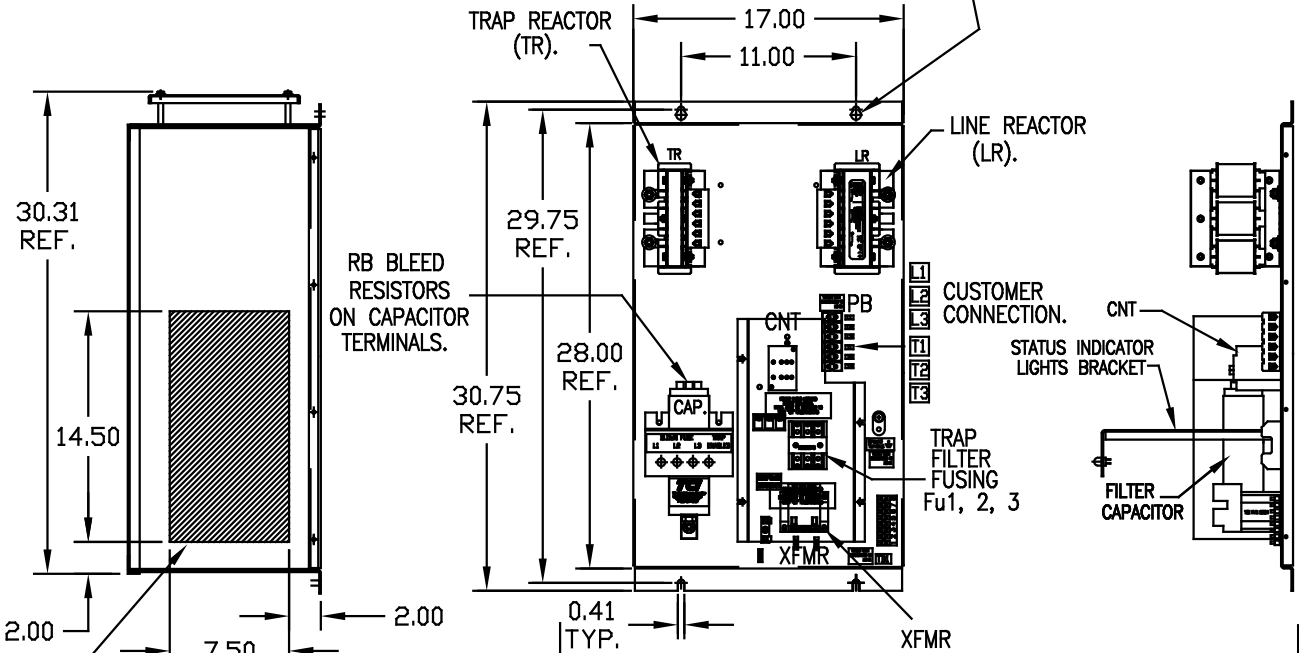
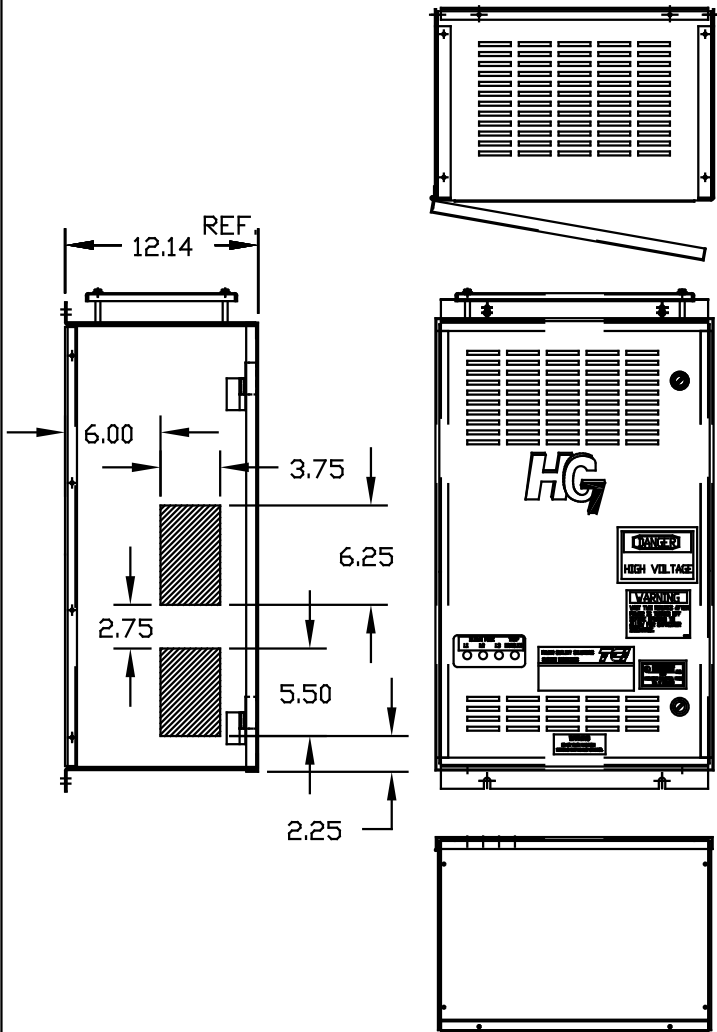
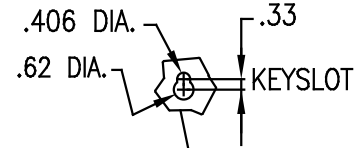

HATCHED AREAS ARE SUGGESTED CUSTOMER WIRE AND EXIT LOCATIONS

ENCLOSURE NOT SHOWN  
 SEE 25334-1 FOR WIRING CONNECTIONS  
 SEE 25334 FOR SCHEMATIC  
 CUSTOMER IS RESPONSIBLE FOR INSTALLATION  
 TO MEET ALL NATIONAL AND LOCAL ELECTRICAL CODES.

PB-POWER INPUT BLOCK:  
 WIRE RANGE-#18 TO #4 AWG.  
 TIGHTENING TORQUE 20 IN.-LB.

GROUND LUG:  
 WIRE RANGE-1/0 TO #14 AWG.  
 TIGHTENING TORQUE 200 IN.-LB.

NO	REVISION	DATE	BY
△	2516, CAP WAS 16446	9/30/07	RJC
NO			

TOLERANCES EXCEPT AS NOTED:
DECIMAL
.XX ±.03
.XXX±.010
FRACTIONAL
± 1/16
ANGULAR
± 1/2°

**TCI** 7878 N. 86th STREET  
 MILWAUKEE, WI 53224

HG10AW01XM, HG7,W/MONITOR  
 10HP, 480/3/60, TYPE1

DRN BY DSW DATE 10/07/05 DVG NO B 102851DG  
 SCALE 1/8"=1" APRVD

SHT.1 OF 1